





SAF

11



www.sampa.com.tr

spare parts for european trucks and trailers

| DESCRIPTION | SAMPA NR. | O.E.M. NR. | | |
|-----------------------------|----------------|--|--------------------|---|
| Bushing For Stabilizer | 010.046 | 1 230 0047 00 | ø25xø35/ø45x28 |  |
| Stabilizer Mounting | 075.002 | 1 230 0131 00 (1 230 0060 00) | ø46x70x70.5/92 |  |
| Stabilizer Mounting | 075.003 | 1 230 0048 00 | ø39.5x69.5x70.5/92 |  |
| Stabilizer Mounting | 075.004 | 1 230 0130 00 (1 230 0063 00) | ø49x70x70.5/90.5 |  |
| Camshaft Support Bush-White | 075.008 | 1 072 0017 01 | ø38xø48x22.5 |  |

SAUER ACHSEN



| | | O.E.M. NR. | SAMPA NR. | DESCRIPTION |
|---|----------------|--|----------------|-------------------------------|
|  | ø38xø48x21,5 | 1 072 0018 00 (1 072 0018 01) | 075.009 | Camshaft Support Bush-Yellow |
|  | ø56xø60x33 | 4 230 0176 00 | 075.010 | Camshaft Support Bush -Bronze |
|  | ø38,2xø42x44,8 | 1 230 0106 04 (1 230 0106 02) (1 230 0106 03) | 075.011 | Camshaft Support Bush-Bronze |
|  | ø38x56 | 1 230 1002 04 (3 230 1002 04) | 075.012 | Spherical Bearing |
|  | ø39xø59,5x38 | 1 230 1002 03 | 075.013 | Spherical Bearing |

O.E.M. Numbers are stated for comparison purposes only. It is not permitted to mention original numbers on invoices owners.

| DESCRIPTION | SAMPA NR. | O.E.M. NR. | | |
|---------------------------|----------------|--|------------------|---|
| Spherical Bearing-Nylon | 075.014 | 1 230 2001 01 (3 230 2001 01) | ø38xø70x63 |  |
| Spherical Bearing Housing | 075.015 | 1 350 2002 01 | ø65x13 |  |
| Spherical Bearing Housing | 075.016 | 1 350 2001 03 (1 350 2001 02) (1 350 2001 01) | ø52.5xø8.5/90x12 |  |
| Spherical Bearing Housing | 075.017 | 1 350 2001 04 | ø52.5xø8.5/90x12 |  |
| Slider-Plastic | 070.041 | 1 318 1001 02 | 69/74x109 |  |

SAUER ACHSEN







| | | O.E.M. NR. | SAMPA NR. | DESCRIPTION |
|---|----------------|----------------------------------|-----------|---------------------|
|  | 111x158x64 | 1 169 0003 01 | 070.040 | Slider-Flat-Plastic |
|  | ø30xø68x104 | 4 177 3010 00 | 075.020 | Bushing For Spring |
|  | M42x3/SW65 | 1 011 0007 00 | 070.036 | Axle Nut |
|  | ø42.5xø59.5x38 | 1 230 1001 01 (1 230 1001 00) | 075.022 | Spherical Bearing |
|  | ø36.5xø59.5x17 | 4 131 0008 00 | 075.023 | Rubber Bush |

O.E.M. Numbers are stated for comparison purposes only. It is not permitted to mention original numbers on invoices owners.

| DESCRIPTION | SAMPA NR. | O.E.M. NR. | | |
|---------------------|----------------|----------------------|------------------|---|
| Compact Cam Bearing | 075.024 | 3 268 0045 00 | ø38x51.5 |  |
| Compact Cam Bearing | 075.025 | 3 268 0046 00 | ø46x78 |  |
| Bushing For Spring | 030.186 | 4 177 0008 00 | ø24xø59x107 |  |
| Hub Cap | 075.029 | 1 304 0016 00 | ø9/140xø165x42.5 |  |
| Hub Cap | 075.030 | 1 304 0046 01 | ø9/185xø205x39.5 |  |

SAUER ACHSEN



| | | O.E.M. NR. | SAMPA NR. | DESCRIPTION |
|---|----------------|----------------------------------|-----------|----------------|
|  | ø40xø50x112 | 1 230 0089 00 | 075.031 | Spring Bushing |
|  | ø5.3xø32.5x232 | 1 447 0058 00 | 075.032 | Return Spring |
|  | ø4xø26x190 | 1 447 0021 01 (1 447 0031 00) | 075.033 | Return Spring |
|  | ø5xø29x168 | 1 447 0033 00 | 075.034 | Return Spring |
|  | ø4.7x29.5x220 | 1 447 0050 00 | 075.035 | Return Spring |

O.E.M. Numbers are stated for comparison purposes only. It is not permitted to mention original numbers on invoices owners.





| DESCRIPTION | SAMPA NR. | O.E.M. NR. | | |
|--------------------|----------------|----------------------------------|----------------|---|
| Gasket | 075.037 | 1 093 0005 00 | ø119xø158x1 |  |
| Gasket | 075.038 | 1 093 0012 00 | ø165xø9/185x1 |  |
| Return Spring | 075.039 | 1 447 0038 00 | ø4.7xø25.5x227 |  |
| Brake Shoe Bushing | 075.040 | 1 230 0035 00 | ø32xø36x40 |  |
| Brake Shoe Bushing | 085.036 | 1 230 0084 01 (1 230 0084 00) | ø32xø35x37 |  |

SAUER ACHSEN



| | | O.E.M. NR. | SAMPA NR. | DESCRIPTION |
|---|---------------|---------------|-----------|---------------------------|
|  | ø38xø42x30 | 1 230 0144 00 | 075.042 | Camshaft Bushing |
|  | ø46xø50x40 | 4 230 0180 00 | 075.043 | Camshaft Bushing |
|  | ø66x13 | 1 350 2005 00 | 075.044 | Spherical Bearing Housing |
|  | ø19x31.7x55.5 | 1 265 0007 00 | 075.045 | Cam Roller |
|  | ø6.3x70 | 1 395 1001 00 | 075.046 | Fulcrum Pin |

O.E.M. Numbers are stated for comparison purposes only. It is not permitted to mention original numbers on invoices owners.

| DESCRIPTION | SAMPA NR. | O.E.M. NR. | | |
|----------------|----------------|----------------------------------|--------------------|---|
| Spring Bushing | 075.047 | 2 095 2039 00 | ø15xø20/ø40x80/101 |  |
| Return Spring | 075.050 | 1 447 0036 00 | ø2.5xø22.5x180 |  |
| Return Spring | 075.051 | 1 447 0037 00 | ø2.8xø25.5x146 |  |
| Fulcrum Pin | 075.052 | 1 395 1013 00 | ø12x64 |  |
| Anchor Pin | 075.056 | 1 214 0023 02 (1 214 0023 01) | ø31.7x72.5 |  |

| | | O.E.M. NR. | SAMPA NR. | DESCRIPTION |
|---|----------------|---------------|-----------|----------------|
|  | ø31.5xø155x114 | 4 177 3028 00 | 075.057 | Rubber Bushing |
|  | ø55xø60x40 | 4 230 0172 01 | 075.058 | Bronze Bushing |
|  | ø20xø36x53 | 1 265 0019 00 | 075.059 | Cam Roller |
|  | ø5xø32x195 | 1 447 0060 00 | 075.060 | Return Spring |
|  | ø50.5xø92x121 | 1 177 2002 00 | 075.061 | Rubber Bushing |

O.E.M. Numbers are stated for comparison purposes only. It is not permitted to mention original numbers on invoices owners.



SAUER ACHSEN

11.11

| DESCRIPTION | SAMPA NR. | O.E.M. NR. | | |
|-----------------------|----------------|----------------------|----------------|---|
| Silent Block | 075.062 | 1 177 1001 02 | ø30.5xø55x61.5 |  |
| Rubber Bushing | 075.063 | 1 177 3004 00 | ø39xø79x59.5 |  |
| Rubber Bushing | 070.059 | 4 177 3016 00 | ø36xø65.5xø68 |  |
| Brake Shoe Spring Pin | 080.130 | 1 395 1005 00 | ø12x64 |  |
| | | | | |

O.E.M. Numbers are stated for comparison purposes only. It is not permitted to mention original numbers on invoices owners.

SAUER ACHSEN

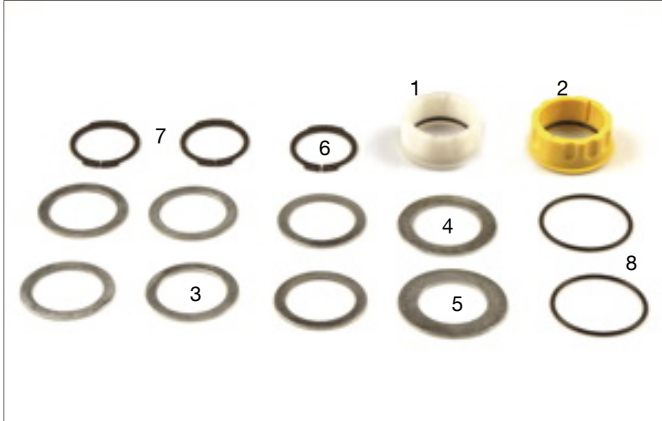

075.509
3 317 0004 00 SMB
Rep.Kit
Brake Camshaft

| | SAMPA NR. | OEM NR. | DESCRIPTION | QTY. |
|---|----------------|--------------------------|--------------------------------|-----------|
| | 075.509 | 3 317 0004 00 SMB | Rep. Kit Brake Camshaft | 15 |
| 1 | 075.008 | 1 072 0017 01 | Camshaft Support Bush-White | 1 |
| 2 | 075.009 | 1 072 0018 00 | Camshaft Support Bush-Yellow | 1 |
| 3 | 105.158 | 1 331 0015 00 | Washer | 6 |
| 4 | 105.159 | 1 133 1002 00 | Washer | 1 |
| 5 | 105.160 | 1 331 0056 00 | Washer | 1 |
| 6 | 106.220 | 4 348 1005 00 | Circlip | 1 |
| 7 | 106.221 | 4 348 1006 00 | Circlip | 2 |
| 8 | 115.514 | 4 315 0003 00 | O-Ring | 2 |
| | | | | |
| | | | | |
| | | | | |
| | | | | |
| | | | | |
| | | | | |
| | | | | |
| | | | | |

RZ 13130
 WRZ 8130/8435/11030/11035

075.510
3 434 3620 00
(3 434 3618 00)
Rep. Kit
Brake Camshaft



| | SAMPA NR. | OEM NR. | DESCRIPTION | QTY. |
|----|----------------|---|--------------------------------|-----------|
| | 075.510 | 3 434 3620 00 | Rep. Kit Brake Camshaft | 44 |
| 1 | 075.012 | 1 230 1002 04 (3 230 1002 04) | Spherical Bearing | 2 |
| 2 | 075.011 | 1 230 0106 04 (1 230 0106 03) (1 230 0106 02) | Support Bush | 2 |
| 3 | 075.050 | 1 447 0036 00 | Return Spring | 2 |
| 4 | 075.017 | 1 350 2001 04 | Spherical Bearing Housing | 4 |
| 5 | 115.511 | 4 315 0048 00 | O-Ring | 2 |
| 6 | 015.012 | 1 094 0034 00 | Plastic Washer | 2 |
| 7 | 015.013 | 1 094 0019 00 | Plastic Washer | 2 |
| 8 | 112.007 | 4 201 0005 00 | Grease Nipple | 2 |
| 9 | 105.158 | 1 331 0015 00 | Washer | 12 |
| 10 | 105.159 | 1 133 1002 00 | Washer | 2 |
| 11 | 105.160 | 1 331 0056 00 | Washer | 2 |
| 12 | 106.220 | 4 348 1005 00 | Circlip | 2 |
| 13 | 106.221 | 4 348 1006 00 | Circlip | 2 |
| 14 | 013.012 | 4 337 2009 00 | Plug | 2 |
| 15 | 115.203 | 1 093 0005 00 | Paper Gasket | 2 |
| 16 | 075.038 | 1 093 0012 00 | Paper Gasket | 2 |

SAUER ACHSEN

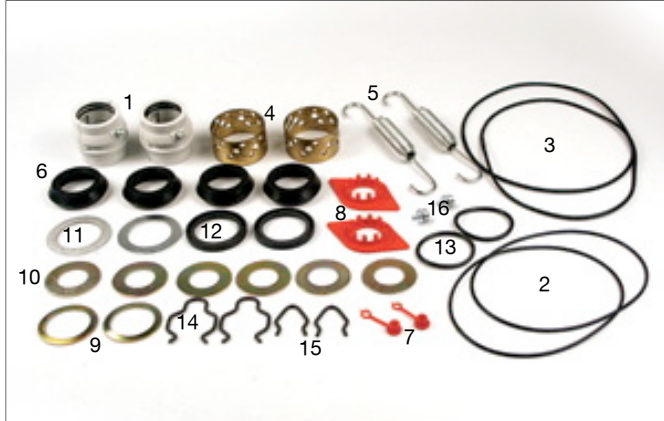

075.511
3 434 3622 00
Rep. Kit
Brake Camshaft

| | SAMPA NR. | OEM NR. | DESCRIPTION | QTY. |
|----|----------------|----------------------------------|--------------------------------|-----------|
| | 075.511 | 3 434 3622 00 | Rep. Kit Brake Camshaft | 38 |
| 1 | 075.012 | 1 230 1002 04 (3 230 1002 04) | Spherical Bearing | 2 |
| 2 | 115.516 | 4 315 0052 00 | O-Ring | 2 |
| 3 | 115.517 | 4 315 0054 00 | O-Ring | 2 |
| 4 | 075.010 | 4 230 0176 00 | Camshaft Support Bush | 2 |
| 5 | 075.050 | 1 447 0036 00 | Return Spring | 2 |
| 6 | 075.023 | 4 131 0008 00 | Rubber Bush | 4 |
| 7 | 013.012 | 4 337 2009 00 | Plug | 2 |
| 8 | 015.022 | 4 187 0010 00 | Plastic Plug-Red | 2 |
| 9 | 105.158 | 1 331 0015 00 | Washer | 2 |
| 10 | 105.162 | 1 331 0176 00 | Washer | 6 |
| 11 | 105.163 | 4 133 1011 00 | Washer | 2 |
| 12 | 115.007 | 4 373 0037 00 | Seal Ring | 2 |
| 13 | 115.515 | 4 315 0059 00 | O-Ring | 2 |
| 14 | 117.002 | 4 151 0010 00 | Spring | 2 |
| 15 | 117.003 | 4 151 0011 00 | Spring | 2 |
| 16 | 112.008 | 4 201 0008 00 | Grease Nipple | 2 |

| | | |
|---------|-------|--------------|
| SKRS/RZ | 9042 | 11.92->08.95 |
| SKRS/RZ | 11242 | 11.92->08.95 |



SAUER ACHSEN

11.19

075.512
3 317 0011 00
Rep. Kit
Brake Camshaft



| | SAMPA NR. | OEM NR. | DESCRIPTION | QTY. |
|---|----------------|----------------------|--------------------------------|-----------|
| | 075.512 | 3 317 0011 00 | Rep. Kit Brake Camshaft | 11 |
| 1 | 015.022 | 4 187 0010 00 | Plastic Plug-Red | 1 |
| 2 | 105.158 | 1 331 0015 00 | Washer | 1 |
| 3 | 105.162 | 1 331 0176 00 | Washer | 3 |
| 4 | 105.163 | 4 133 1011 00 | Washer | 1 |
| 5 | 115.007 | 4 373 0037 00 | Seal Ring | 1 |
| 6 | 115.515 | 4 315 0059 00 | O-Ring | 1 |
| 7 | 117.002 | 4 151 0010 00 | Spring | 1 |
| 8 | 117.003 | 4 151 0011 00 | Spring | 1 |
| 9 | 112.008 | 4 201 0008 00 | Grease Nipple | 1 |
| | | | | |
| | | | | |
| | | | | |
| | | | | |
| | | | | |

SKRS/RZ 9042 11.92->08.95
 SKRS/RZ 11242 11.92->08.95

SAUER ACHSEN



075.513

-

**Rep. Kit
Brake Camshaft**

| | SAMPA NR. | OEM NR. | DESCRIPTION | QTY. |
|----|----------------|----------------------------------|--------------------------------|-----------|
| | 075.513 | - | Rep. Kit Brake Camshaft | 17 |
| 1 | 075.008 | 1 072 0017 01 | Camshaft Support Bush-White | 1 |
| 2 | 075.009 | 1 072 0018 00 (1 072 0018 01) | Camshaft Support Bush-Yellow | 1 |
| 3 | 075.014 | 1 230 2001 01 | Spherical Bearing | 1 |
| 4 | 105.158 | 1 331 0015 00 | Washer | 6 |
| 5 | 105.159 | 1 133 1002 00 | Washer | 1 |
| 6 | 105.160 | 1 331 0056 00 | Washer | 2 |
| 7 | 115.514 | 4 315 0003 00 | O-Ring | 2 |
| 8 | 106.220 | 4 348 1005 00 | Circlip | 1 |
| 9 | 106.221 | 4 348 1006 00 | Circlip | 1 |
| 10 | 112.007 | 4 201 0005 00 | Grease Nipple | 1 |
| | | | | |
| | | | | |
| | | | | |
| | | | | |

075.514
-
Rep. Kit
Brake Camshaft



| | SAMPA NR. | OEM NR. | DESCRIPTION | QTY. |
|---|----------------|----------------------------------|--------------------------------|-----------|
| | 075.514 | - | Rep. Kit Brake Camshaft | 40 |
| 1 | 075.012 | 1 230 1002 04 (3 230 1002 04) | Spherical Bearing | 2 |
| 2 | 075.017 | 1 350 2001 04 | Spherical Bearing Housing | 4 |
| 3 | 075.023 | 4 131 0008 00 | Rubber Bush | 4 |
| 4 | 102.123 | 4 343 1022 04 | Screw | 10 |
| 5 | 104.108 | 4 247 4015 80 | Nut | 10 |
| 6 | 107.001 | 4 141 0001 00 | Rondela | 10 |

075.515
-
Rep. Kit
Brake Camshaft



| | SAMPA NR. | OEM NR. | DESCRIPTION | QTY. |
|---|----------------|----------------------------------|--------------------------------|-----------|
| | 075.515 | - | Rep. Kit Brake Camshaft | 26 |
| 1 | 075.014 | 1 230 2001 01 (3 230 2001 01) | Spherical Bearing | 2 |
| 2 | 075.015 | 1 350 2002 01 | Spherical Bearing Housing | 4 |
| 3 | 104.108 | 4 247 4015 80 | Nut | 4 |
| 4 | 107.001 | 4 141 0001 00 | Rondela | 4 |
| 5 | 102.123 | 4 343 1022 04 | Screw | 4 |
| 6 | 102.108 | - | Screw | 4 |
| 7 | 104.103 | - | Nut | 4 |



075.516
3 434 3601 00
Rep. Kit
Brake Camshaft

| | SAMPA NR. | OEM NR. | DESCRIPTION | QTY. |
|----|----------------|----------------------|--------------------------------|-----------|
| | 075.516 | 3 434 3601 00 | Rep. Kit Brake Camshaft | 32 |
| 1 | 105.311 | 1 331 0014 00 | Washer | 2 |
| 2 | 075.050 | 1 447 0036 00 | Return Spring | 2 |
| 3 | 075.011 | 1 230 0106 04 | Camshaft Support Bush | 2 |
| | | (1 230 0106 03) | | |
| | | (1 230 0106 02) | | |
| 4 | 106.220 | 4 348 1005 00 | Circlip | 2 |
| 5 | 115.513 | 4 315 0001 01 | O-Ring | 2 |
| 6 | 106.221 | 4 348 1006 00 | Circlip | 2 |
| 7 | 015.013 | 1 094 0019 00 | Plastic Washer | 2 |
| 8 | 105.046 | - | Washer | 12 |
| 9 | 105.159 | 1 133 1002 00 | Washer | 2 |
| 10 | 115.203 | 1 093 0005 00 | Paper Gasket | 2 |
| 11 | 075.013 | 1 230 1002 03 | Spherical Bearing | 2 |

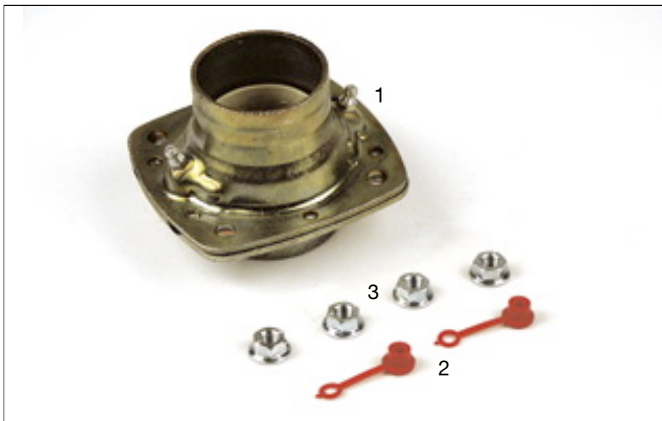

075.517
3 268 0048 00
Rep. Kit
Brake Camshaft

| | SAMPA NR. | OEM NR. | DESCRIPTION | QTY. |
|---|----------------|----------------------|--------------------------------|----------|
| | 075.517 | 3 268 0048 00 | Rep. Kit Brake Camshaft | 7 |
| 1 | 075.025 | 3 268 0046 00 | Compact Cam Bearing | 1 |
| 2 | 013.012 | 4 337 2009 00 | Plug | 2 |
| 3 | 104.138 | 4 247 4042 10 | Nut | 4 |

075.518
3 268 0047 00
Rep. Kit
Brake Camshaft



| | SAMPA NR. | OEM NR. | DESCRIPTION | QTY. |
|---|----------------|----------------------|--------------------------------|----------|
| | 075.518 | 3 268 0047 00 | Rep. Kit Brake Camshaft | 9 |
| 1 | 075.024 | 3 268 0045 00 | Compact Cam Bearing | 1 |
| 2 | 013.012 | 4 337 2009 00 | Plug | 1 |
| 3 | 075.023 | 4 131 0008 00 | Rubber Bush | 2 |
| 4 | 102.338 | 4 343 2912 01 | Screw | 5 |
| | | | | |
| | | | | |
| | | | | |
| | | | | |

075.519
3 005 0147 00
Dust Cover Set



| | SAMPA NR. | OEM NR. | DESCRIPTION | QTY. |
|---|----------------|----------------------|-----------------------|-----------|
| | 075.519 | 3 005 0147 00 | Dust Cover Set | 19 |
| 1 | 102.132 | 4 375 2003 88 | Screw | 6 |
| 2 | 107.001 | 4 141 0001 00 | Rondela | 6 |
| 3 | 013.009 | 4 337 2027 00 | Plug | 2 |
| 4 | 211.048 | 4 177 3018 00 | Rubber Plug | 1 |
| 5 | 211.049 | 4 337 2008 01 | Rubber Plug | 2 |
| 6 | 114.125 | 1 005 0147 00 | Dust Cover | 1 |
| 7 | 114.126 | 1 005 0148 00 | Dust Cover | 1 |
| | | | | |
| | | | | |
| | | | | |
| | | | | |



075.520
3 005 0173 00
Dust Cover Set

| | SAMPA NR. | OEM NR. | DESCRIPTION | QTY. |
|---|----------------|----------------------|-----------------------|----------|
| | 075.520 | 3 005 0173 00 | Dust Cover Set | 9 |
| 1 | 102.152 | 4 343 1075 88 | Screw | 1 |
| 2 | 109.007 | 4 194 2023 01 | Metal Clamp | 1 |
| 3 | 013.009 | 4 337 2027 00 | Plug | 2 |
| 4 | 211.048 | 4 177 3018 00 | Rubber Plug | 1 |
| 5 | 211.049 | 4 337 2008 01 | Rubber Plug | 2 |
| 6 | 114.127 | 1 005 0173 00 | Dust Cover | 1 |
| 7 | 114.128 | 1 005 0174 00 | Dust Cover | 1 |



075.521
3 005 0117 01
Dust Cover Set

| | SAMPA NR. | OEM NR. | DESCRIPTION | QTY. |
|---|----------------|----------------------|-----------------------|-----------|
| | 075.521 | 3 005 0117 01 | Dust Cover Set | 19 |
| 1 | 102.132 | 4 375 2003 88 | Screw | 6 |
| 2 | 107.001 | 4 141 0001 00 | Rondela | 6 |
| 3 | 013.009 | 4 337 2027 00 | Plug | 2 |
| 4 | 211.048 | 4 177 3018 00 | Rubber Plug | 1 |
| 5 | 211.049 | 4 337 2008 01 | Rubber Plug | 2 |
| 6 | 114.129 | 1 005 0116 01 | Dust Cover | 1 |
| 7 | 114.130 | 1 005 0117 01 | Dust Cover | 1 |

075.522
3 005 0141 00
Dust Cover Set



| | SAMPA NR. | OEM NR. | DESCRIPTION | QTY. |
|---|----------------|----------------------|-----------------------|----------|
| | 075.522 | 3 005 0141 00 | Dust Cover Set | 9 |
| 1 | 102.152 | 4 343 1075 88 | Screw | 1 |
| 2 | 109.007 | 4 194 2023 01 | Metal Clamp | 1 |
| 3 | 013.009 | 4 337 2027 00 | Plug | 2 |
| 4 | 211.048 | 4 177 3018 00 | Rubber Plug | 1 |
| 5 | 211.049 | 4 337 2008 01 | Rubber Plug | 2 |
| 6 | 114.131 | 1 005 0140 00 | Dust Cover | 1 |
| 7 | 114.132 | 1 005 0141 00 | Dust Cover | 1 |
| | | | | |
| | | | | |
| | | | | |

075.523
3 005 0055 00
Dust Cover Set



| | SAMPA NR. | OEM NR. | DESCRIPTION | QTY. |
|---|----------------|----------------------|-----------------------|-----------|
| | 075.523 | 3 005 0055 00 | Dust Cover Set | 14 |
| 1 | 102.132 | 4 375 2003 88 | Screw | 4 |
| 2 | 107.001 | 4 141 0001 00 | Rondela | 4 |
| 3 | 013.009 | 4 337 2027 00 | Plug | 2 |
| 4 | 013.010 | 4 337 2007 00 | Plug | 2 |
| 5 | 114.133 | 1 005 0055 00 | Dust Cover | 1 |
| 6 | 114.134 | 1 005 0056 00 | Dust Cover | 1 |
| | | | | |
| | | | | |
| | | | | |

SAUER ACHSEN

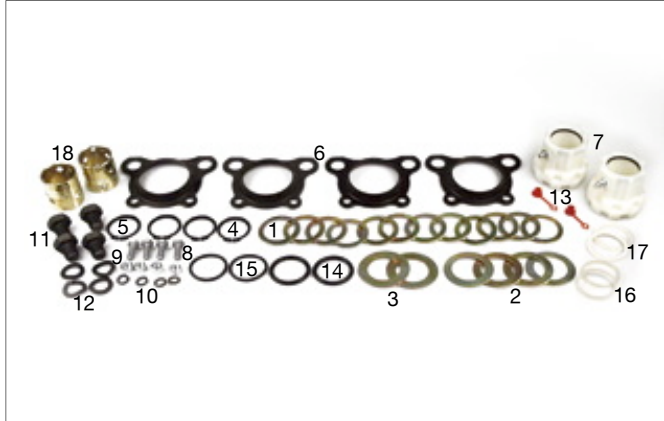

075.524
3 434 3637 00
Rep. Kit
Brake Camshaft

| | SAMPA NR. | OEM NR. | DESCRIPTION | QTY. |
|----|----------------|---|--------------------------------|-----------|
| | 075.524 | 3 434 3637 00 | Rep. Kit Brake Camshaft | 60 |
| 1 | 105.158 | 1 331 0015 00 | Washer | 12 |
| 2 | 105.159 | 1 133 1002 00 | Washer | 4 |
| 3 | 105.160 | 1 331 0056 00 | Washer | 2 |
| 4 | 106.220 | 4 348 1005 00 | Circlip | 2 |
| 5 | 106.221 | 4 348 1006 00 | Circlip | 2 |
| 6 | 075.044 | 1 350 2005 00 | Spherical Bearing Housing | 4 |
| 7 | 075.014 | 1 230 2001 01 (3 230 2001 01) | Spherical Bearing | 2 |
| 8 | 102.103 | 4 343 1015 88 | Screw | 4 |
| 9 | 104.109 | 4 342 0013 80 | Nut | 4 |
| 10 | 107.001 | 4 141 0001 00 | Rondela | 4 |
| 11 | 102.153 | 4 343 1061 88 | Screw | 4 |
| 12 | 107.030 | 4 141 0006 00 | Rondela | 4 |
| 13 | 013.012 | 4 337 2009 00 | Plug | 2 |
| 14 | 115.511 | 4 315 0048 00 | O-Ring | 2 |
| 15 | 115.513 | 4 315 0001 01 | O-Ring | 2 |
| 16 | 015.012 | 1 094 0034 00 | Plastic Washer | 2 |
| 17 | 015.013 | 1 094 0019 00 | Plastic Washer | 2 |
| 18 | 075.011 | 1 230 0106 04 (1 230 0106 03) (1 230 0106 02) | Camshaft Support Bush | 2 |

075.525
3 268 0006 00
Rep. Kit
Brake Camshaft



| | SAMPA NR. | OEM NR. | DESCRIPTION | QTY. |
|---|----------------|----------------------------------|--------------------------------|-----------|
| | 075.525 | 3 268 0006 00 | Rep. Kit Brake Camshaft | 30 |
| 1 | 075.044 | 1 350 2005 00 | Spherical Bearing Housing | 4 |
| 2 | 075.014 | 1 230 2001 01 (3 230 2001 01) | Spherical Bearing | 2 |
| 3 | 102.103 | 4 343 1015 88 | Screw | 4 |
| 4 | 104.109 | 4 342 0013 80 | Nut | 4 |
| 5 | 107.001 | 4 141 0001 00 | Rondela | 4 |
| 6 | 102.153 | 4 343 1061 88 | Screw | 4 |
| 7 | 107.030 | 4 141 0006 00 | Rondela | 4 |
| 8 | 105.159 | 1 133 1002 00 | Washer | 2 |
| 9 | 013.012 | 4 337 2009 00 | Plug | 2 |

075.526
3 317 0010 00
Rep. Kit
Brake Camshaft

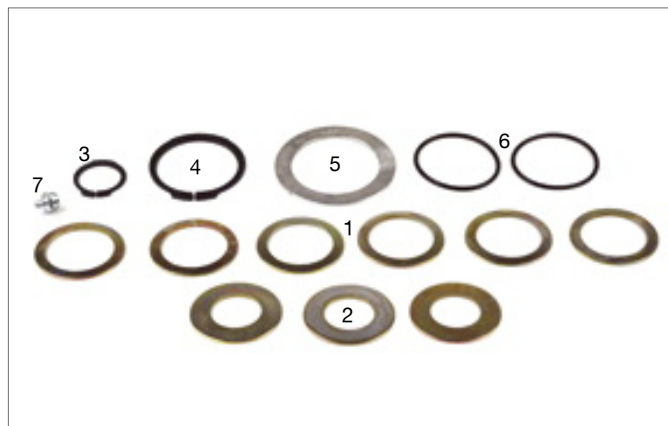

| | SAMPA NR. | OEM NR. | DESCRIPTION | QTY. |
|---|----------------|----------------------|--------------------------------|-----------|
| | 075.526 | 3 317 0010 00 | Rep. Kit Brake Camshaft | 15 |
| 1 | 105.158 | 1 331 0015 00 | Washer | 6 |
| 2 | 105.162 | 1 331 0176 00 | Washer | 3 |
| 3 | 106.247 | 4 348 1014 00 | Circlip | 1 |
| 4 | 106.248 | 4 348 1029 00 | Circlip | 1 |
| 5 | 105.199 | 4 133 1010 00 | Washer | 1 |
| 6 | 115.575 | 4 315 0055 00 | O-Ring | 2 |
| 7 | 112.008 | 4 201 0008 00 | Grease Nipple | 1 |

SAUER ACHSEN



075.527
3 317 0009 00
Rep. Kit
Brake Camshaft

| | SAMPA NR. | OEM NR. | DESCRIPTION | QTY. |
|---|----------------|----------------------|--------------------------------|-----------|
| | 075.527 | 3 317 0009 00 | Rep. Kit Brake Camshaft | 11 |
| 1 | 105.158 | 1 331 0015 00 | Washer | 6 |
| 2 | 105.160 | 1 331 0056 00 | Washer | 1 |
| 3 | 105.001 | 1 331 0078 00 | Washer | 1 |
| 4 | 106.220 | 4 348 1005 00 | Circlip | 1 |
| 5 | 106.221 | 4 348 1006 00 | Circlip | 1 |
| 6 | 105.159 | 1 133 1002 00 | Washer | 1 |
| | | | | |
| | | | | |
| | | | | |
| | | | | |
| | | | | |
| | | | | |
| | | | | |
| | | | | |
| | | | | |



SAUER ACHSEN

075.528
3 434 3636 00
Rep. Kit
Brake Camshaft



| | SAMPA NR. | OEM NR. | DESCRIPTION | QTY. |
|----|----------------|---|--------------------------------|-----------|
| | 075.528 | 3 434 3636 00 | Rep. Kit Brake Camshaft | 72 |
| 1 | 015.013 | 1 094 0019 00 | Plastic Washer | 2 |
| 2 | 015.012 | 1 094 0034 00 | Plastic Washer | 2 |
| 3 | 075.011 | 1 230 0106 04 (1 230 0106 03) (1 230 0106 02) | Camshaft Support Bush | 2 |
| 4 | 115.513 | 4 315 0001 01 | O-Ring | 2 |
| 5 | 115.511 | 4 315 0048 00 | O-Ring | 2 |
| 6 | 105.158 | 1 331 0015 00 | Washer | 12 |
| 7 | 105.159 | 1 133 1002 00 | Washer | 2 |
| 8 | 105.160 | 1 331 0056 00 | Washer | 2 |
| 9 | 106.220 | 4 348 1005 00 | Circlip | 2 |
| 10 | 106.221 | 4 348 1006 00 | Circlip | 2 |
| 11 | 075.012 | 1 230 1002 04 (3 230 1002 04) | Spherical Bearing | 2 |
| 12 | 075.017 | 1 350 2001 04 | Spherical Bearing Housing | 4 |
| 13 | 075.023 | 4 131 0008 00 | Rubber Bushing | 4 |
| 14 | 104.109 | 4 342 0013 80 | Nut | 10 |
| 15 | 102.123 | 4 343 1022 88 | Screw | 10 |
| 16 | 107.001 | 4 141 0001 00 | Rondela | 10 |
| 17 | 013.012 | 4 337 2009 00 | Plug | 2 |



075.529
3 434 3638 00
Rep. Kit
Brake Camshaft

| | SAMPA NR. | OEM NR. | DESCRIPTION | QTY. |
|----|----------------|----------------------------------|--------------------------------|-----------|
| | 075.529 | 3 434 3638 00 | Rep. Kit Brake Camshaft | 44 |
| 1 | 075.043 | 4 230 0180 00 | Bushing | 2 |
| 2 | 013.012 | 4 337 2009 00 | Plug | 2 |
| 3 | 075.012 | 1 230 1002 04 (3 230 1002 04) | Spherical Bearing | 2 |
| 4 | 075.023 | 4 131 0008 00 | Rubber Bush | 4 |
| 5 | 115.516 | 4 315 0052 00 | O-Ring | 2 |
| 6 | 115.517 | 4 315 0054 00 | O-Ring | 2 |
| 7 | 115.557 | 4 315 0056 00 | O-Ring | 2 |
| 8 | 075.050 | 1 447 0036 00 | Return Spring | 2 |
| 9 | 115.558 | 4 315 0062 00 | O-Ring | 2 |
| 10 | 015.040 | 1 094 0039 00 | Plastic Washer | 2 |
| 11 | 105.162 | 1 331 0176 00 | Washer | 6 |
| 12 | 117.002 | 4 151 0010 00 | Spring | 2 |
| 13 | 117.003 | 4 151 0011 00 | Spring | 2 |
| 14 | 105.163 | 4 133 1011 00 | Washer | 2 |
| 15 | 105.158 | 1 331 0015 00 | Washer | 2 |
| 16 | 115.007 | 4 373 0037 00 | Seal Ring | 2 |
| 17 | 015.022 | 4 187 0010 00 | Plastic Plug-Red | 2 |
| 18 | 115.511 | 4 315 0048 00 | O-Ring | 4 |



SAUER ACHSEN

075.530
3 317 0016 00
Rep. Kit
Brake Camshaft



| | SAMPA NR. | OEM NR. | DESCRIPTION | QTY. |
|----|----------------|----------------------|--------------------------------|-----------|
| | 075.530 | 3 317 0016 00 | Rep. Kit Brake Camshaft | 13 |
| 1 | 115.558 | 4 315 0062 00 | O-Ring | 1 |
| 2 | 015.040 | 1 094 0039 00 | Plastic Washer | 1 |
| 3 | 105.162 | 1 331 0176 00 | Washer | 3 |
| 4 | 117.002 | 4 151 0010 00 | Spring | 1 |
| 5 | 117.003 | 4 151 0011 00 | Spring | 1 |
| 6 | 105.163 | 4 133 1011 00 | Washer | 1 |
| 7 | 105.158 | 1 331 0015 00 | Washer | 1 |
| 8 | 115.007 | 4 373 0037 00 | Seal Ring | 1 |
| 9 | 015.022 | 4 187 0010 00 | Plastic Plug-Red | 1 |
| 10 | 115.511 | 4 315 0048 00 | O-Ring | 2 |

075.531
3 317 0036 00
Rep. Kit
Brake Camshaft



| | SAMPA NR. | OEM NR. | DESCRIPTION | QTY. |
|---|----------------|----------------------|--------------------------------|-----------|
| | 075.531 | 3 317 0036 00 | Rep. Kit Brake Camshaft | 10 |
| 1 | 105.162 | 1 331 0176 00 | Washer | 3 |
| 2 | 105.158 | 1 331 0015 00 | Washer | 1 |
| 3 | 105.163 | 4 133 1011 00 | Washer | 1 |
| 4 | 117.003 | 4 151 0011 00 | Spring | 1 |
| 5 | 117.002 | 4 151 0010 00 | Spring | 1 |
| 6 | 015.022 | 4 187 0010 00 | Plastic Plug-Red | 1 |
| 7 | 115.511 | 4 315 0048 00 | O-ring | 2 |

O.E.M. Numbers are stated for comparison purposes only. It is not permitted to mention original numbers on invoices owners.



075.532
3 005 0009 02
Dust Cover Set

| | SAMPA NR. | OEM NR. | DESCRIPTION | QTY. |
|---|----------------|----------------------|-----------------------|-----------|
| | 075.532 | 3 005 0009 02 | Dust Cover Set | 19 |
| 1 | 102.132 | 4 375 2003 88 | Screw | 6 |
| 2 | 107.001 | 4 141 0001 00 | Rondela | 6 |
| 3 | 013.009 | 4 337 2027 00 | Plug | 2 |
| 4 | 211.049 | 4 337 2008 01 | Rubber Plug | 2 |
| 5 | 211.048 | 4 177 3018 00 | Rubber Plug | 1 |
| 6 | 114.135 | 1 005 0009 02 | Dust Cover | 1 |
| 7 | 114.136 | 1 005 0010 02 | Dust Cover | 1 |

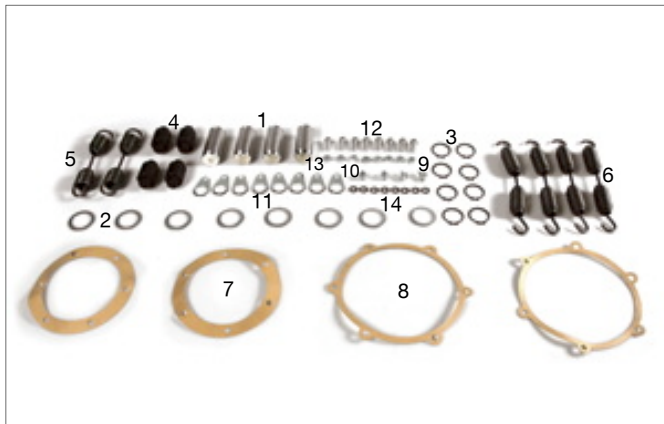

075.533
3 434 3602 00
Brake Shoes Rep. Kit

| | SAMPA NR. | OEM NR. | DESCRIPTION | QTY. |
|----|----------------|----------------------------------|-----------------------------|-----------|
| | 075.533 | 3 434 3602 00 | Brake Shoes Rep. Kit | 70 |
| 1 | 075.056 | 1 214 0023 02 (1 214 0023 01) | Anchor Pin | 4 |
| 2 | 105.026 | 1 131 0013 00 | Washer | 8 |
| 3 | 106.201 | 4 348 1004 00 | Circlip | 8 |
| 4 | 075.045 | 1 265 0007 00 | Cam Roller | 4 |
| 5 | 075.034 | 1 447 0033 00 | Return Spring | 2 |
| 6 | 075.039 | 1 447 0038 00 | Return Spring | 4 |
| 7 | 115.203 | 1 093 0005 00 | Paper Gasket | 2 |
| 8 | 075.038 | 1 093 0012 00 | Paper Gasket | 2 |
| 9 | 112.007 | 4 201 0005 00 | Grease Nipple | 2 |
| 10 | 112.008 | 4 201 0008 00 | Grease Nipple | 2 |
| 11 | 114.144 | 1 345 0006 00 | Lock Plattes | 8 |
| 12 | 102.103 | 4 343 1015 88 | Screw | 8 |
| 13 | 104.108 | 4 247 4015 80 | Nut | 8 |
| 14 | 107.001 | 4 141 0001 00 | Rondela | 8 |

075.534
3 268 0034 00
Rep. Kit
Brake Camshaft



| | SAMPA NR. | OEM NR. | DESCRIPTION | QTY. |
|---|----------------|-------------------------------|--------------------------------|-----------|
| | 075.534 | 3 268 0034 00 | Rep. Kit Brake Camshaft | 21 |
| 1 | 075.012 | 1 230 1002 04-(3 230 1002 04) | Spherical Bearing | 1 |
| 2 | 075.017 | 1 350 2001 04 | Spherical Bearing Housing | 2 |
| 3 | 075.023 | 4 131 0008 00 | Rubber Bush | 2 |
| 4 | 104.109 | 4 342 0013 80 | Nut | 5 |
| 5 | 102.123 | 4 343 1022 88 | Screw | 5 |
| 6 | 107.001 | 4 141 0001 00 | Rondela | 5 |
| 7 | 013.012 | 4 337 2009 00 | Plug | 1 |

075.535
3 213 0023 01
(3 213 0023 02)
Rep. Kit Brake Shoe



| | SAMPA NR. | OEM NR. | DESCRIPTION | QTY. |
|---|----------------|----------------------------------|----------------------------|----------|
| | 075.535 | 3 213 0023 01 | Rep. Kit Brake Shoe | 5 |
| 1 | 075.056 | 1 214 0023 02 (1 214 0023 01) | Anchor Pin | 1 |
| 2 | 105.026 | 1 331 0013 00 | Washer | 2 |
| 3 | 106.201 | 4 348 1004 00 | Circlip | 2 |

SAUER ACHSEN

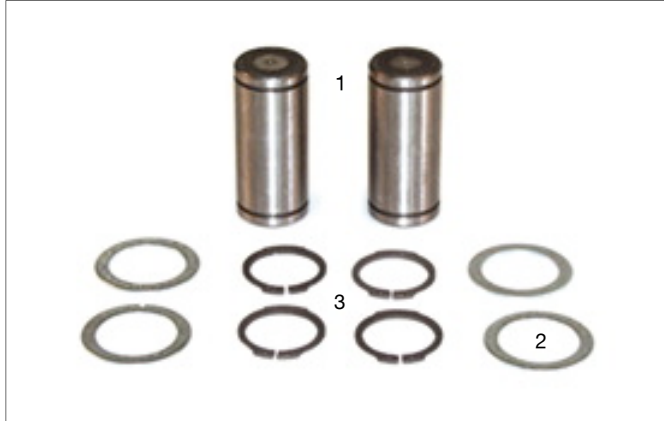

075.535/1
3 213 0023 01
(3 213 0023 02 S)
Rep. Kit Brake Shoe

| | SAMPA NR. | OEM NR. | DESCRIPTION | QTY. |
|---|------------------|----------------------------------|----------------------------|-----------|
| | 075.535/1 | 3 213 0023 01 | Rep. Kit Brake Shoe | 10 |
| 1 | 075.056 | 1 214 0023 02 (1 214 0023 01) | Anchor Pin | 2 |
| 2 | 105.026 | 1 331 0013 00 | Washer | 4 |
| 3 | 106.201 | 4 348 1004 00 | Circlip | 4 |
| | | | | |
| | | | | |
| | | | | |
| | | | | |



075.536
3 317 0005 00
Rep. Kit
Brake Camshaft

| | SAMPA NR. | OEM NR. | DESCRIPTION | QTY. |
|---|----------------|----------------------|--------------------------------|----------|
| | 075.536 | 3 317 0005 00 | Rep. Kit Brake Camshaft | 9 |
| 1 | 105.027 | 1 331 0009 00 | Washer | 5 |
| 2 | 106.242 | 4 348 1007 00 | Circlip | 2 |
| 3 | 106.220 | 4 348 1005 00 | Circlip | 1 |
| 4 | 112.005 | 4 201 0004 00 | Grease Nipple | 1 |
| | | | | |
| | | | | |
| | | | | |
| | | | | |

075.537
3 434 3604 00
Rep. Kit
Brake Camshaft

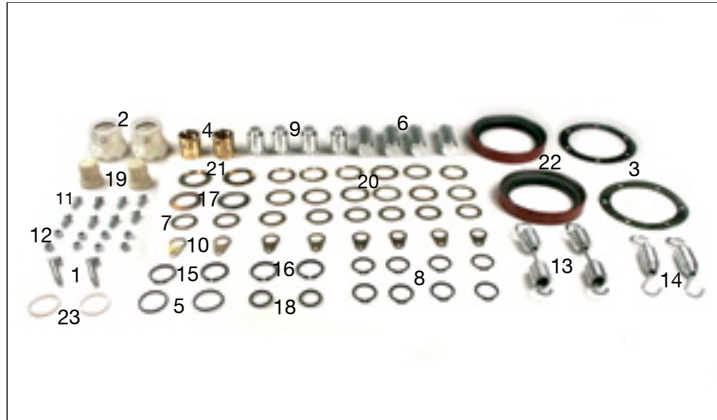

| | SAMPA NR. | OEM NR. | DESCRIPTION | QTY. |
|----|----------------|---|--------------------------------|-----------|
| | 075.537 | 3 434 3604 00 | Rep. Kit Brake Camshaft | 90 |
| 1 | 112.020 | 4 201 0016 00 | Grease Nipple | 2 |
| 2 | 075.014 | 1 230 2001 01 (3 230 2001 01) | Spherical Bearing | 2 |
| 3 | 115.203 | 1 093 0005 00 | Paper Gasket | 2 |
| 4 | 075.011 | 1 230 0106 04 (1 230 0106 03) (1 230 0106 02) | Camshaft Support Bush | 2 |
| 5 | 115.513 | 4 315 0001 01 | O-Ring | 2 |
| 6 | 075.056 | 1 214 0023 02 (1 214 0023 01) | Anchor Pin | 4 |
| 7 | 105.026 | 1 331 0013 00 | Washer | 8 |
| 8 | 106.201 | 4 348 1004 00 | Circlip | 8 |
| 9 | 075.045 | 1 265 0007 00 | Cam Roller | 4 |
| 10 | 114.144 | 1 345 0006 00 | Lock Plates | 8 |
| 11 | 102.103 | 4 343 1015 88 | Screw | 8 |
| 12 | 104.108 | 4 247 4015 80 | Nut | 8 |
| 13 | 075.034 | 1 447 0033 00 | Return Spring | 2 |
| 14 | 075.051 | 1 447 0037 00 | Return Spring | 2 |
| 15 | 106.220 | 4 348 1005 00 | Circlip | 2 |
| 16 | 106.221 | 4 348 1006 00 | Circlip | 2 |
| 17 | 105.159 | 1 133 1002 00 | Washer | 2 |
| 18 | 115.510 | 4 315 0050 00 | O-Ring | 2 |
| 19 | 015.014 | 4 230 0171 00 | Plastic Bush | 2 |
| 20 | 105.158 | 1 331 0015 00 | Washer | 12 |
| 21 | 105.198 | 1 331 0056 00 | Washer | 2 |
| 22 | 115.052 | - | Seal Ring | 2 |
| 23 | 015.013 | 1 094 0019 00 | Plastic Washer | 2 |

SAUER ACHSEN

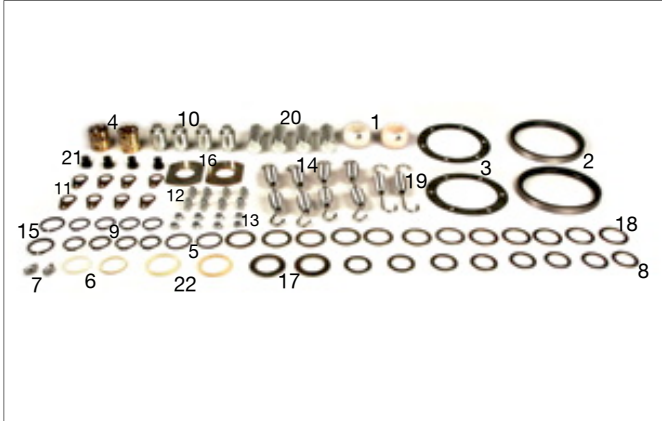

075.538
3 434 3600 00
Rep. Kit
Brake Camshaft

| | SAMPA NR. | OEM NR. | DESCRIPTION | QTY. |
|----|----------------|----------------------|--------------------------------|-----------|
| | 075.538 | 3 434 3600 00 | Rep. Kit Brake Camshaft | 92 |
| 1 | 075.013 | 1 230 1002 03 | Spherical Bearing | 2 |
| 2 | 115.053 | 4 373 0010 00 | Seal Ring | 2 |
| 3 | 115.203 | 1 093 0005 00 | Paper Gasket | 2 |
| 4 | 075.011 | 1 230 0106 04 | Camshaft Support Bush | 2 |
| | | (1 230 0106 03) | | |
| | | (1 230 0106 02) | | |
| 5 | 115.513 | 4 315 0001 01 | O-Ring | 2 |
| 6 | 015.013 | 1 094 0019 00 | Plastic Washer | 2 |
| 7 | 112.007 | 4 201 0005 00 | Grease Nipple | 2 |
| 8 | 105.026 | 1 331 0013 00 | Washer | 8 |
| 9 | 106.201 | 4 348 1004 00 | Circlip | 8 |
| 10 | 075.045 | 1 265 0007 00 | Cam Roller | 4 |
| 11 | 114.144 | 1 345 0006 00 | Lock Plates | 8 |
| 12 | 102.103 | 4 343 1015 88 | Screw | 8 |
| 13 | 104.108 | 4 247 4015 80 | Nut | 8 |
| 14 | 075.039 | 1 447 0038 00 | Return Spring | 4 |
| 15 | 106.221 | 4 348 1006 00 | Circlip | 2 |
| 16 | 105.311 | 1 331 0014 00 | Washer | 2 |
| 17 | 105.159 | 1 133 1002 00 | Washer | 2 |
| 18 | 105.158 | 1 331 0015 00 | Washer | 12 |
| 19 | 075.050 | 1 447 0036 00 | Return Spring | 2 |
| 20 | 075.056 | 1 214 0023 02 | Anchor Pin | 4 |
| | | (1 210 0023 01) | | |
| 21 | 211.052 | - | Rubber Plug | 4 |
| 22 | 015.040 | 1 094 0039 00 | Plastic Washer | 2 |

075.539
3 227 0190 00
 (5 399 0020 70)
Spring and Assembly
Suspension

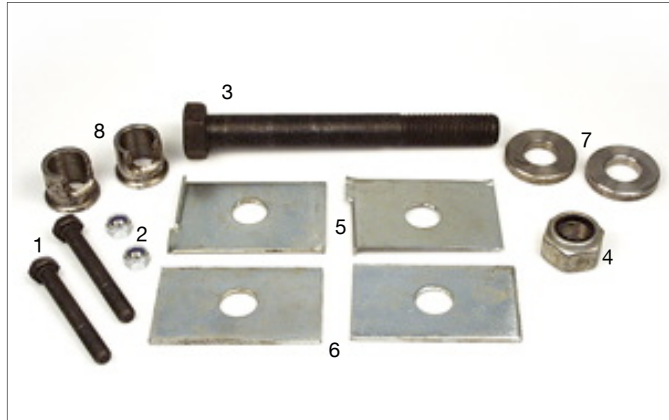

| | SAMPA NR. | OEM NR. | DESCRIPTION | QTY. |
|---|----------------|----------------------|---------------------------------------|-----------|
| | 075.539 | 3 227 0190 00 | Spring and Assembly Suspension | 14 |
| 1 | 102.154 | 4 343 0013 88 | Screw | 2 |
| 2 | 104.112 | 4 247 4007 80 | Nut | 2 |
| 3 | 102.155 | 4 343 0080 88 | Screw | 1 |
| 4 | 104.142 | 4 247 4022 80 | Nut | 1 |
| 5 | 114.147 | 1 022 1003 01 | Washer | 2 |
| 6 | 114.148 | 1 331 5012 01 | Washer | 2 |
| 7 | 105.254 | 4 331 2200 00 | Washer | 2 |
| 8 | 110.045 | 1 072 0077 00 | Bushing | 2 |

075.540
3 341 1048 19
Bolt Kit for Air
Suspension

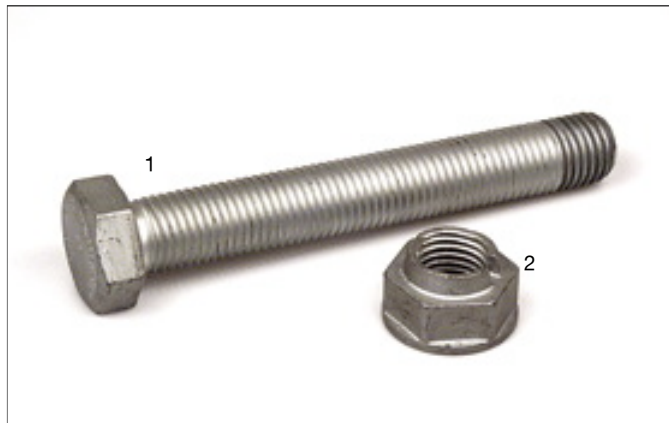

| | SAMPA NR. | OEM NR. | DESCRIPTION | QTY. |
|---|----------------|----------------------|------------------------------------|----------|
| | 075.540 | 3 341 1048 19 | Bolt Kit for Air Suspension | 2 |
| 1 | 102.156 | 4 343 1048 88 | Bolt | 1 |
| 2 | 104.142 | 4 247 4022 80 | Nut | 1 |



SAUER ACHSEN

075.542
3 434 3639 00
Rep. Kit
Brake Camshaft



| | SAMPA NR. | OEM NR. | DESCRIPTION | QTY. |
|----|----------------|----------------------|--------------------------------|-----------|
| | 075.542 | 3 434 3639 00 | Rep. Kit Brake Camshaft | 66 |
| 1 | 075.023 | 4 131 0008 00 | Dust Cover | 4 |
| 2 | 075.024 | 3 268 0045 00 | Compact Cam Bearing | 2 |
| 3 | 075.025 | 3 268 0046 00 | Compact Cam Bearing | 2 |
| 4 | 075.051 | 1 447 0037 00 | Return Spring | 2 |
| 5 | 013.012 | 4 337 2009 00 | Plug | 6 |
| 6 | 015.022 | 4 187 0010 00 | Plastic Plug-Red | 2 |
| 7 | 015.040 | 1 094 0039 00 | Plastic Washer | 2 |
| 8 | 102.338 | 4 343 2912 01 | Screw | 10 |
| 9 | 104.138 | 4 247 4042 10 | Nut | 8 |
| 10 | 105.158 | 1 331 0015 00 | Washer | 2 |
| 11 | 105.162 | 1 331 0176 00 | Washer | 6 |
| 12 | 105.163 | 4 133 1011 00 | Washer | 2 |
| 13 | 115.007 | 4 373 0037 00 | Seal ring | 2 |
| 14 | 115.511 | 4 315 0048 00 | O-Ring | 4 |
| 15 | 115.516 | 4 315 0052 00 | O-Ring | 2 |
| 16 | 115.517 | 4 315 0054 00 | O-Ring | 2 |
| 17 | 115.557 | 4 315 0056 00 | O-Ring | 2 |
| 18 | 115.558 | 4 315 0062 00 | O-Ring | 2 |
| 19 | 117.002 | 4 151 0010 00 | Spring | 2 |
| 20 | 117.003 | 4 151 0011 00 | Spring | 2 |



075.543

-
Dust Cover Set
ø230xø445x65

| | SAMPA NR. | OEM NR. | DESCRIPTION | QTY. |
|---|----------------|---------------|-----------------------|-----------|
| | 075.543 | - | Dust Cover Set | 19 |
| 1 | 114.202 | - | Dust Cover | 1 |
| 2 | 114.203 | - | Dust Cover | 1 |
| 3 | 102.132 | 4 375 2003 88 | Screw | 6 |
| 4 | 107.001 | 4 141 0001 00 | Rondela | 6 |
| 5 | 013.009 | 4 337 2027 00 | Plug | 2 |
| 6 | 211.048 | 4 177 3018 00 | Rubber Plug | 1 |
| 7 | 211.049 | 4 337 2008 01 | Rubber Plug | 2 |



075.544

3 005 0037 03
Dust Cover Set

| | SAMPA NR. | OEM NR. | DESCRIPTION | QTY. |
|---|----------------|----------------------|-----------------------|-----------|
| | 075.544 | 3 005 0037 03 | Dust Cover Set | 22 |
| 1 | 114.188 | 1 005 0036 03 | Dust Cover | 1 |
| 2 | 114.189 | 1 005 0037 03 | Dust Cover | 1 |
| 3 | 211.049 | 4 337 2008 01 | Rubber Plug | 4 |
| 4 | 211.048 | 4 177 3018 00 | Rubber Plug | 1 |
| 5 | 013.009 | 4 337 2027 00 | Plug | 2 |
| 6 | 013.010 | 4 337 2007 00 | Plug | 1 |
| 7 | 102.132 | 4 375 2003 88 | Screw | 6 |
| 8 | 107.001 | 4 141 0001 00 | Rondela | 6 |

075.545
3 268 0008 01
Camshaft Bearing
Assembly Kit

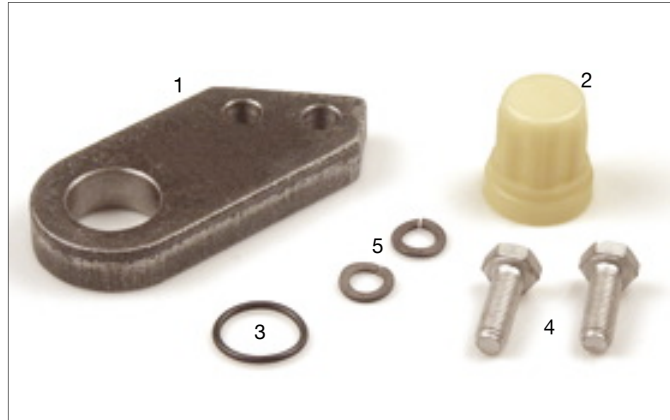

| | SAMPA NR. | OEM NR. | DESCRIPTION | QTY. |
|---|----------------|----------------------|--------------------------------------|----------|
| | 075.545 | 3 268 0008 01 | Camshaft Bearing Assembly Kit | 7 |
| 1 | 118.007 | 1 212 0026 00 | Trunning Block | 1 |
| 2 | 015.014 | 4 230 0171 00 | Plastic Bushing | 1 |
| 3 | 115.510 | 4 315 0050 00 | O-Ring | 1 |
| 4 | 102.181 | 4 343 1017 88 | Screw | 2 |
| 5 | 107.005 | 4 141 0003 00 | Rondela | 2 |
| | | | | |
| | | | | |
| | | | | |

075.546
3 434 3643 00
Spring Bearing Rep. Kit

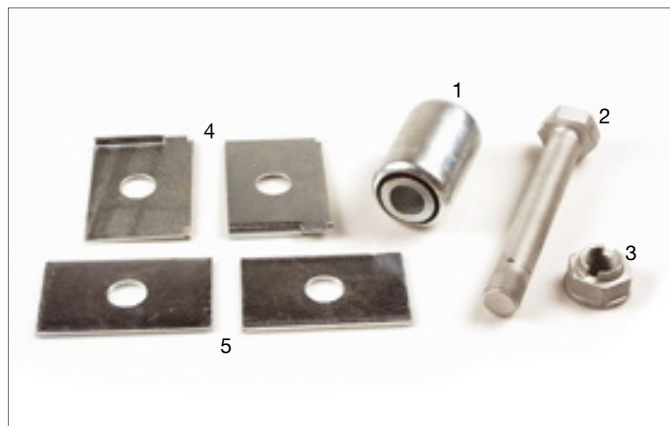

| | SAMPA NR. | OEM NR. | DESCRIPTION | QTY. |
|---|----------------|----------------------|--------------------------------|----------|
| | 075.546 | 3 434 3643 00 | Spring Bearing Rep. Kit | 7 |
| 1 | 075.020 | 4 177 3010 00 | Bushing for Spring | 1 |
| 2 | 102.156 | 4 343 1048 88 | Screw | 1 |
| 3 | 104.142 | 4 247 4022 80 | Nut | 1 |
| 4 | 114.147 | 1 022 1003 02 | Washer | 2 |
| 5 | 114.148 | 1 331 5012 01 | Washer | 2 |
| | | | | |
| | | | | |
| | | | | |



075.547
3 434 3644 00
Spring Bearing Rep. Kit

| | SAMPA NR. | OEM NR. | DESCRIPTION | QTY. |
|---|----------------|----------------------|--------------------------------|----------|
| | 075.547 | 3 434 3644 00 | Spring Bearing Rep. Kit | 4 |
| 1 | 114.207 | 4 405 2071 00 | U-Profile | 1 |
| 2 | 075.020 | 4 177 3010 00 | Bushing for Spring | 1 |
| 3 | 102.182 | 4 343 1053 00 | Screw | 1 |
| 4 | 104.142 | 4 247 4022 80 | Nut | 1 |
| | | | | |
| | | | | |
| | | | | |
| | | | | |

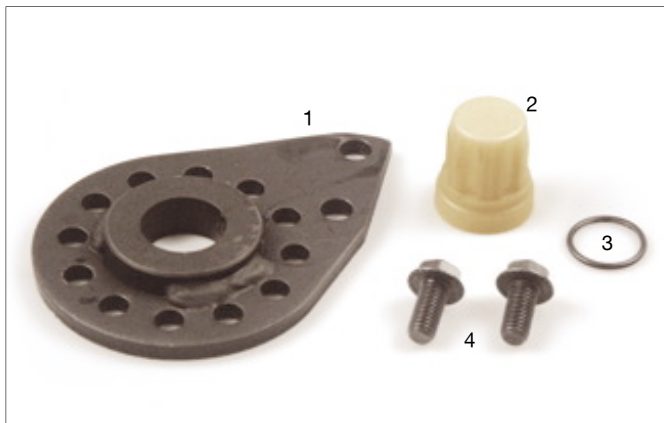

075.548
3 268 0033 00
Camshaft Bearing
Assembly Kit

| | SAMPA NR. | OEM NR. | DESCRIPTION | QTY. |
|---|----------------|----------------------|--------------------------------------|----------|
| | 075.548 | 3 268 0033 00 | Camshaft Bearing Assembly Kit | 5 |
| 1 | 118.008 | 2 043 1045 00 | Mounting Plate | 1 |
| 2 | 015.014 | 4 230 0171 00 | Plastic Bushing | 1 |
| 3 | 115.510 | 4 315 0050 00 | O-Ring | 1 |
| 4 | 102.348 | 4 343 2911 00 | Screw | 2 |
| | | | | |
| | | | | |
| | | | | |
| | | | | |

075.549
3 268 0037 00
Camshaft Bearing
Assembly Kit

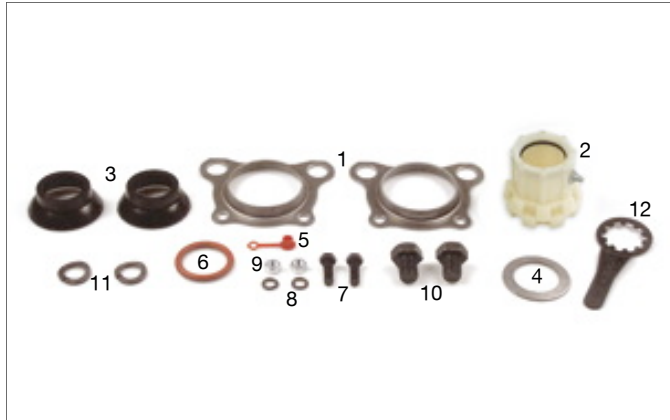

| | SAMPA NR. | OEM NR. | DESCRIPTION | QTY. |
|----|----------------|----------------------|--------------------------------------|-----------|
| | 075.549 | 3 268 0037 00 | Camshaft Bearing Assembly Kit | 19 |
| 1 | 075.044 | 1 350 2005 00 | Spherical Bearing Housing | 2 |
| 2 | 075.014 | 1 230 2001 01 | Spherical Bearing | 1 |
| 3 | 211.075 | 1 173 3002 00 | Seal | 2 |
| 4 | 105.159 | 1 133 1002 00 | Washer | 1 |
| 5 | 013.012 | 4 337 2009 00 | Plug | 1 |
| 6 | 115.578 | 4 315 0047 00 | O-Ring | 1 |
| 7 | 102.103 | 4 343 1015 88 | Screw | 2 |
| 8 | 107.001 | 4 141 0001 00 | Rondela | 2 |
| 9 | 104.109 | 4 342 0013 80 | Nut | 2 |
| 10 | 102.153 | 4 343 1061 88 | Screw | 2 |
| 11 | 107.030 | 4 141 0006 00 | Rondela | 2 |
| 12 | 015.047 | 4 187 0009 00 | Wearing Gauge | 1 |

075.550
3 268 0032 00
Camshaft Bearing
Assembly Kit

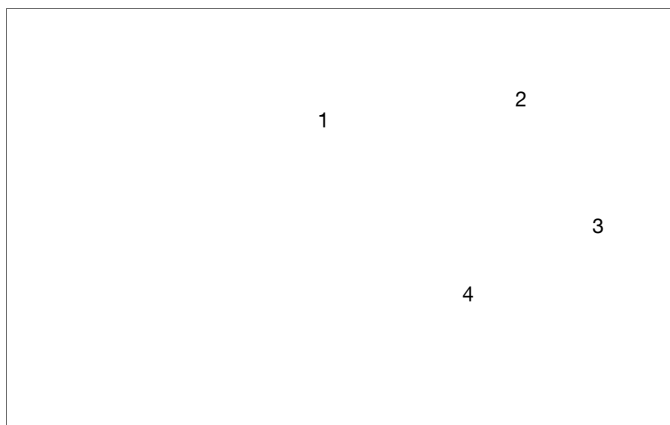

| | SAMPA NR. | OEM NR. | DESCRIPTION | QTY. |
|---|----------------|----------------------|--------------------------------------|----------|
| | 075.550 | 3 268 0032 00 | Camshaft Bearing Assembly Kit | 5 |
| 1 | 118.009 | 2 043 1046 00 | Mounting Plate | 1 |
| 2 | 015.014 | 4 230 0171 00 | Plastic Bushing | 1 |
| 3 | 115.510 | 4 315 0050 00 | O-Ring | 1 |
| 4 | 102.348 | 4 343 2911 00 | Screw | 2 |



SAUER ACHSEN

075.552
3 434 3652 00
Camshaft Bearing
Rep. Kit



| | SAMPA NR. | OEM NR. | DESCRIPTION | QTY. |
|----|----------------|----------------------|----------------------------------|-----------|
| | 075.552 | 3 434 3652 00 | Camshaft Bearing Rep. Kit | 62 |
| 1 | 075.050 | 1 447 0036 00 | Return Spring | 2 |
| 2 | 115.582 | 4 315 0064 00 | O-Ring | 2 |
| 3 | 115.558 | 4 315 0062 00 | O-Ring | 2 |
| 4 | 015.040 | 1 094 0039 00 | Plastic Washer | 2 |
| 5 | 105.162 | 1 331 0176 00 | Washer | 6 |
| 6 | 117.002 | 4 151 0010 00 | Spring | 2 |
| 7 | 117.003 | 4 151 0011 00 | Spring | 2 |
| 8 | 105.163 | 4 133 1011 00 | Washer | 2 |
| 9 | 105.158 | 1 331 0015 00 | Washer | 2 |
| 10 | 115.007 | 4 373 0037 00 | Seal Ring | 2 |
| 11 | 015.022 | 4 187 0010 00 | Plastic Plug-Red | 2 |
| 12 | 115.511 | 4 315 0048 00 | O-Ring | 4 |
| 13 | 075.024 | 3 268 0045 00 | Compact Cam Bearing | 2 |
| 14 | 013.012 | 4 337 2009 00 | Plug | 6 |
| 15 | 075.023 | 4 131 0008 00 | Rubber Bush | 4 |
| 16 | 102.338 | 4 343 2912 01 | Screw | 10 |
| 17 | 075.025 | 3 268 0046 00 | Compact Cam Bearing | 2 |
| 18 | 104.138 | 4 247 4042 10 | Nut | 8 |
| | | | | |
| | | | | |
| | | | | |
| | | | | |

SAUER ACHSEN



075.553
3 434 3614 00
Camshaft Bearing
Rep. Kit

| | SAMPA NR. | OEM NR. | DESCRIPTION | QTY. |
|----|----------------|-----------------------------|----------------------------------|-----------|
| | 075.553 | 3 434 3614 00 | Camshaft Bearing Rep. Kit | 46 |
| 1 | 115.558 | 4 315 0062 00 | O-Ring | 2 |
| 2 | 015.040 | 1 094 0039 00 | Plastic Washer | 2 |
| 3 | 105.162 | 1 331 0176 00 | Washer | 6 |
| 4 | 117.002 | 4 151 0010 00 | Spring | 2 |
| 5 | 117.003 | 4 151 0011 00 | Spring | 2 |
| 6 | 105.163 | 4 133 1011 00 | Washer | 2 |
| 7 | 105.158 | 1 331 0015 00 | Washer | 2 |
| 8 | 115.007 | 4 373 0037 00 | Seal Ring | 2 |
| 9 | 015.022 | 4 187 0010 00 | Plastic Plug-Red | 2 |
| 10 | 115.511 | 4 315 0048 00 | O-Ring | 4 |
| 11 | 075.012 | 1 230 1002 04-3 230 1002 04 | Spherical Bearing | 2 |
| 12 | 075.043 | 4 230 0180 00 | Bronze Bushing | 2 |
| 13 | 075.023 | 4 131 0008 00 | Rubber Bush | 4 |
| 14 | 075.051 | 1 447 0037 00 | Return Spring | 2 |
| 15 | 112.022 | 4 201 0026 00 | Grease Nipple | 2 |
| 16 | 112.008 | 4 201 0008 00 | Grease Nipple | 2 |
| 17 | 115.579 | 4 315 0060 00 | O-Ring | 2 |
| 18 | 115.580 | 4 315 0061 00 | O-Ring | 2 |
| 19 | 115.581 | 4 315 0066 00 | O-Ring | 2 |

075.554
3 434 3613 00
Camshaft Bearing
Rep. Kit

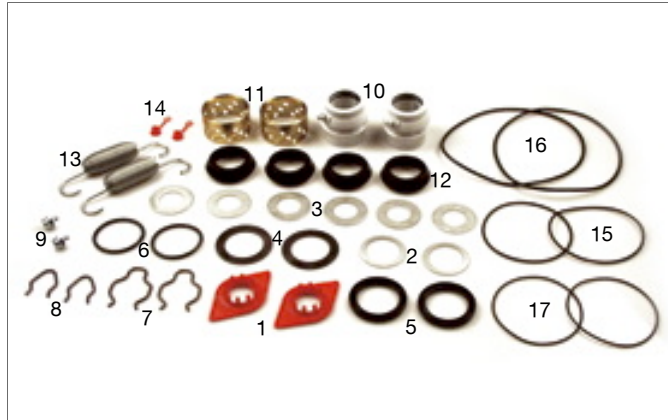

| | SAMPA NR. | OEM NR. | DESCRIPTION | QTY. |
|----|----------------|-----------------------------|----------------------------------|-----------|
| | 075.554 | 3 434 3613 00 | Camshaft Bearing Rep. Kit | 40 |
| 1 | 015.022 | 4 187 0010 00 | Plastic Plug-Red | 2 |
| 2 | 105.158 | 1 331 0015 00 | Washer | 2 |
| 3 | 105.162 | 1 331 0176 00 | Washer | 6 |
| 4 | 105.163 | 4 133 1011 00 | Washer | 2 |
| 5 | 115.007 | 4 373 0037 00 | Seal ring | 2 |
| 6 | 115.515 | 4 315 0059 00 | O-Ring | 2 |
| 7 | 117.002 | 4 151 0010 00 | Spring | 2 |
| 8 | 117.003 | 4 151 0011 00 | Spring | 2 |
| 9 | 112.008 | 4 201 0008 00 | Grease Nipple | 2 |
| 10 | 075.012 | 1 230 1002 04-3 230 1002 04 | Spherical Bearing | 2 |
| 11 | 075.010 | 4 230 0176 00 | Camshaft Support Bush | 2 |
| 12 | 075.023 | 4 131 0008 00 | Rubber Bush | 4 |
| 13 | 075.051 | 1 447 0037 00 | Return Spring | 2 |
| 14 | 013.012 | 4 337 2009 00 | Plug | 2 |
| 15 | 115.579 | 4 315 0060 00 | O-Ring | 2 |
| 16 | 115.580 | 4 315 0061 00 | O-Ring | 2 |
| 17 | 115.581 | 4 315 0066 00 | O-Ring | 2 |
| | | | | |
| | | | | |
| | | | | |
| | | | | |



SAUER ACHSEN

075.556
3 434 3610 00
Camshaft Bearing
Rep. Kit



| | SAMPA NR. | OEM NR. | DESCRIPTION | QTY. |
|----|----------------|-------------------------------|----------------------------------|-----------|
| | 075.556 | 3 434 3610 00 | Camshaft Bearing Rep. Kit | 42 |
| 1 | 115.558 | 4 315 0062 00 | O-Ring | 2 |
| 2 | 015.040 | 1 094 0039 00 | Plastic Washer | 2 |
| 3 | 105.162 | 1 331 0176 00 | Washer | 6 |
| 4 | 117.002 | 4 151 0010 00 | Spring | 2 |
| 5 | 117.003 | 4 151 0011 00 | Spring | 2 |
| 6 | 105.163 | 4 133 1011 00 | Washer | 2 |
| 7 | 105.158 | 1 331 0015 00 | Washer | 2 |
| 8 | 115.007 | 4 373 0037 00 | Seal Ring | 2 |
| 9 | 015.022 | 4 187 0010 00 | Plastic Plug-Red | 2 |
| 10 | 115.511 | 4 315 0048 00 | O-Ring | 4 |
| 11 | 075.043 | 4 230 0180 00 | Bronze Bushing | 2 |
| 12 | 075.012 | 1 230 1002 04-(3 230 1002 04) | Spherical Bearing | 2 |
| 13 | 075.023 | 4 131 0008 00 | Rubber Bush | 4 |
| 14 | 115.582 | 4 315 0064 00 | O-Ring | 2 |
| 15 | 112.008 | 4 201 0008 00 | Grease Nipple | 2 |
| 16 | 112.001 | 4 201 0001 00 | Grease Nipple | 2 |
| 17 | 075.051 | 1 447 0037 00 | Return Spring | 2 |
| | | | | |
| | | | | |
| | | | | |



075.557
3 434 3634 00
Camshaft Bearing
Rep. Kit

| | SAMPA NR. | OEM NR. | DESCRIPTION | QTY. |
|----|----------------|-----------------------------|----------------------------------|-----------|
| | 075.557 | 3 434 3634 00 | Camshaft Bearing Rep. Kit | 38 |
| 1 | 015.022 | 4 187 0010 00 | Plastic Plug-Red | 2 |
| 2 | 105.158 | 1 331 0015 00 | Washer | 2 |
| 3 | 105.162 | 1 331 0176 00 | Washer | 6 |
| 4 | 105.163 | 4 133 1011 00 | Washer | 2 |
| 5 | 115.007 | 4 373 0037 00 | Seal Ring | 2 |
| 6 | 115.515 | 4 315 0059 00 | O-Ring | 2 |
| 7 | 117.002 | 4 151 0010 00 | Spring | 2 |
| 8 | 117.003 | 4 151 0011 00 | Spring | 2 |
| 9 | 112.008 | 4 201 0008 00 | Grease Nipple | 2 |
| 10 | 075.012 | 1 230 1002 04-3 230 1002 04 | Spherical Bearing | 2 |
| 11 | 075.023 | 4 131 0008 00 | Rubber Bush | 4 |
| 12 | 075.010 | 4 230 0176 00 | Camshaft Support Bush | 2 |
| 13 | 013.012 | 4 337 2009 00 | Plug | 2 |
| 14 | 075.050 | 1 447 0036 00 | Return Spring | 2 |
| 15 | 115.579 | 4 315 0060 00 | O-Ring | 2 |
| 16 | 115.580 | 4 315 0061 00 | O-Ring | 2 |
| | | | | |
| | | | | |
| | | | | |
| | | | | |
| | | | | |



SAUER ACHSEN

075.558
3 434 3642 00
Camshaft Bearing
Rep. Kit



| | SAMPA NR. | OEM NR. | DESCRIPTION | QTY. |
|----|----------------|----------------------|----------------------------------|-----------|
| | 075.558 | 3 434 3642 00 | Camshaft Bearing Rep. Kit | 66 |
| 1 | 075.051 | 1 447 0037 00 | Return Spring | 2 |
| 2 | 115.558 | 4 315 0062 00 | O-Ring | 2 |
| 3 | 015.040 | 1 094 0039 00 | Plastic Washer | 2 |
| 4 | 105.162 | 1 331 0176 00 | Washer | 6 |
| 5 | 117.002 | 4 151 0010 00 | Spring | 2 |
| 6 | 117.003 | 4 151 0011 00 | Spring | 2 |
| 7 | 105.163 | 4 133 1011 00 | Washer | 2 |
| 8 | 105.158 | 1 331 0015 00 | Washer | 2 |
| 9 | 115.007 | 4 373 0037 00 | Seal Ring | 2 |
| 10 | 015.022 | 4 187 0010 00 | Plastic Plug-Red | 2 |
| 11 | 115.511 | 4 315 0048 00 | O-Ring | 4 |
| 12 | 075.024 | 3 268 0045 00 | Compact Cam Bearing | 2 |
| 13 | 013.012 | 4 337 2009 00 | Plug | 6 |
| 14 | 075.023 | 4 131 0008 00 | Rubber Bush | 4 |
| 15 | 102.338 | 4 343 2912 01 | Screw | 10 |
| 16 | 075.025 | 3 268 0046 00 | Compact Cam Bearing | 2 |
| 17 | 104.138 | 4 247 4042 10 | Nut | 8 |
| 18 | 115.579 | 4 315 0060 00 | O-Ring | 2 |
| 19 | 115.580 | 4 315 0061 00 | O-Ring | 2 |
| 20 | 115.581 | 4 315 0066 00 | O-Ring | 2 |

SAUER ACHSEN



075.559
3 434 3608 00
Repair Kit Brake

| | SAMPA NR. | OEM NR. | DESCRIPTION | QTY. |
|---|----------------|----------------------|-------------------------|-----------|
| | 075.559 | 3 434 3608 00 | Repair Kit Brake | 10 |
| 1 | 115.582 | 4 315 0064 00 | O-Ring | 2 |
| 2 | 075.059 | 1 265 0019 00 | Cam Roller | 4 |
| 3 | 114.208 | 1 151 0013 00 | Spring Clamp | 2 |
| 4 | 075.060 | 1 447 0060 00 | Return Spring | 2 |
| | | | | |
| | | | | |
| | | | | |
| | | | | |

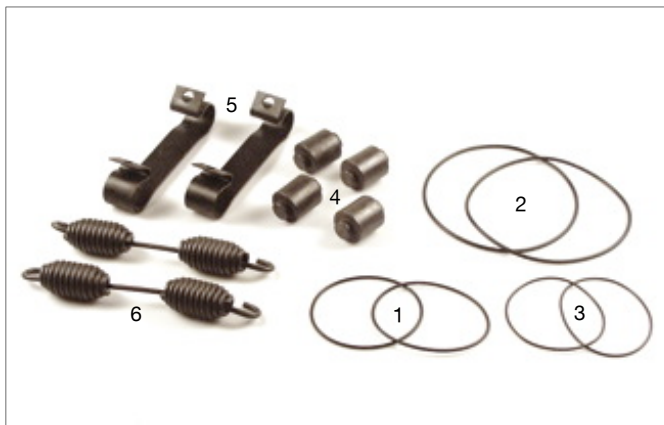

075.560
3 434 3615 00
Repair Kit Brake

| | SAMPA NR. | OEM NR. | DESCRIPTION | QTY. |
|---|----------------|----------------------|-------------------------|-----------|
| | 075.560 | 3 434 3615 00 | Repair Kit Brake | 14 |
| 1 | 115.579 | 4 315 0060 00 | O-Ring | 2 |
| 2 | 115.580 | 4 315 0061 00 | O-Ring | 2 |
| 3 | 115.581 | 4 315 0066 00 | O-Ring | 2 |
| 4 | 075.059 | 1 265 0019 00 | Cam Roller | 4 |
| 5 | 114.209 | 1 151 0008 00 | Spring Clamp | 2 |
| 6 | 075.032 | 1 447 0058 00 | Return Spring | 2 |
| | | | | |
| | | | | |
| | | | | |
| | | | | |

075.561
3 434 3640 00
Camshaft Bearing
Rep. Kit



| | SAMPA NR. | OEM NR. | DESCRIPTION | QTY. |
|----|----------------|----------------------|----------------------------------|-----------|
| | 075.561 | 3 434 3640 00 | Camshaft Bearing Rep. Kit | 58 |
| 1 | 115.558 | 4 315 0062 00 | O-Ring | 2 |
| 2 | 015.040 | 1 094 0039 00 | Plastic Washer | 2 |
| 3 | 105.162 | 1 331 0176 00 | Washer | 6 |
| 4 | 117.002 | 4 151 0010 00 | Spring | 2 |
| 5 | 117.003 | 4 151 0011 00 | Spring | 2 |
| 6 | 105.163 | 4 133 1011 00 | Washer | 2 |
| 7 | 105.158 | 1 331 0015 00 | Washer | 2 |
| 8 | 115.007 | 4 373 0037 00 | Seal Ring | 2 |
| 9 | 015.022 | 4 187 0010 00 | Plastic Plug-Red | 2 |
| 10 | 115.511 | 4 315 0048 00 | O-Ring | 4 |
| 11 | 075.024 | 3 268 0045 00 | Compact Cam Bearing | 2 |
| 12 | 013.012 | 4 337 2009 00 | Plug | 4 |
| 13 | 075.023 | 4 131 0008 00 | Rubber Bush | 4 |
| 14 | 102.338 | 4 343 2912 01 | Screw | 10 |
| 15 | 075.043 | 4 230 0180 00 | Bronze Bushing | 2 |
| 16 | 112.022 | 4 201 0026 00 | Grease Nipple | 2 |
| 17 | 075.051 | 1 447 0037 00 | Return Spring | 2 |
| 18 | 115.579 | 4 315 0060 00 | O-Ring | 2 |
| 19 | 115.580 | 4 315 0061 00 | O-Ring | 2 |
| 20 | 115.581 | 4 315 0066 00 | O-Ring | 2 |



075.562
3 268 0035 00
Camshaft Bearing
Assembly Rep. Kit

| | SAMPA NR. | OEM NR. | DESCRIPTION | QTY. |
|---|----------------|-----------------------------|---|-----------|
| | 075.562 | 3 268 0035 00 | Camshaft Bearing Assembly Rep. Kit | 23 |
| 1 | 075.017 | 1 350 2001 04 | Spherical Bearing Housing | 2 |
| 2 | 075.012 | 1 230 1002 04-3 230 1002 04 | Spherical Bearing | 1 |
| 3 | 075.023 | 4 131 0008 00 | Rubber Bush | 2 |
| 4 | 211.075 | 1 173 3002 00 | Seal | 1 |
| 5 | 015.047 | 4 187 0009 00 | Wearing Gauge | 1 |
| 6 | 013.012 | 4 337 2009 00 | Plug | 1 |
| 7 | 104.109 | 4 342 0013 80 | Nut | 5 |
| 8 | 102.123 | 4 343 1022 88 | Screw | 5 |
| 9 | 107.001 | 4 141 0001 00 | Rondela | 5 |

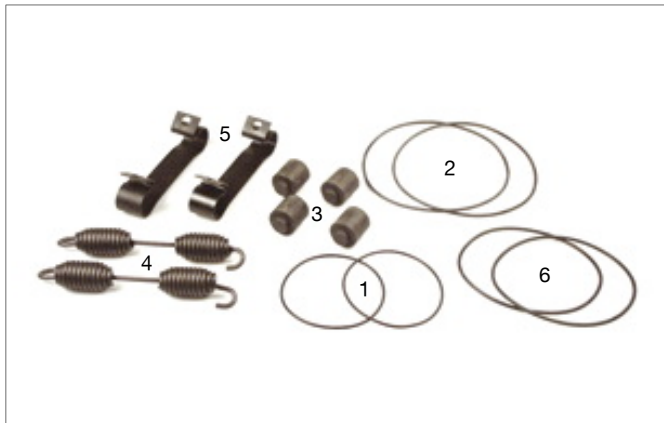

075.563
3 434 3612 00
Repair Kit Brake

| | SAMPA NR. | OEM NR. | DESCRIPTION | QTY. |
|---|----------------|----------------------|-------------------------|-----------|
| | 075.563 | 3 434 3612 00 | Repair Kit Brake | 14 |
| 1 | 115.516 | 4 315 0052 00 | O-Ring | 2 |
| 2 | 115.517 | 4 315 0054 00 | O-Ring | 2 |
| 3 | 075.059 | 1 265 0019 00 | Cam Roller | 4 |
| 4 | 075.032 | 1 447 0058 00 | Return Spring | 2 |
| 5 | 114.209 | 1 151 0008 00 | Spring Clamp | 2 |
| 6 | 115.582 | 4 315 0064 00 | O-Ring | 2 |



SAUER ACHSEN

075.564
3 434 3635 00
Brake Rep. Kit



| | SAMPA NR. | OEM NR. | DESCRIPTION | QTY. |
|---|----------------|----------------------|-----------------------|-----------|
| | 075.564 | 3 434 3635 00 | Brake Rep. Kit | 12 |
| 1 | 115.579 | 4 315 0060 00 | O-Ring | 2 |
| 2 | 115.580 | 4 315 0061 00 | O-Ring | 2 |
| 3 | 075.059 | 1 265 0019 00 | Cam Roller | 4 |
| 4 | 075.032 | 1 447 0058 00 | Return Spring | 2 |
| 5 | 114.209 | 1 151 0008 00 | Spring Clamp | 2 |
| | | | | |
| | | | | |
| | | | | |
| | | | | |
| | | | | |
| | | | | |
| | | | | |
| | | | | |
| | | | | |

O.E.M. Numbers are stated for comparison purposes only. It is not permitted to mention original numbers on invoices owners.



075.565

-

Brake Shoe Rep. Kit

| | SAMPA NR. | OEM NR. | DESCRIPTION | QTY. |
|----|----------------|----------------------------------|----------------------------|-----------|
| | 075.565 | - | Brake Shoe Rep. Kit | 29 |
| 1 | 075.034 | 1 447 0033 00 | Return Spring | 1 |
| 2 | 075.056 | 1 214 0023 02 (1 214 0023 01) | Anchor Pin | 2 |
| 3 | 105.026 | 1 331 0013 00 | Washer | 4 |
| 4 | 106.201 | 4 348 1004 00 | Circlip | 4 |
| 5 | 075.045 | 1 265 0007 00 | Cam Roller | 2 |
| 6 | 075.052 | 1 395 1013 00 | Fulcrum Pin | 2 |
| 7 | 085.036 | 1 230 0084 01 | Bushing | 2 |
| 8 | 114.144 | 1 345 0006 00 | Lock Plate | 4 |
| 9 | 102.103 | 4 343 1015 88 | Screw | 4 |
| 10 | 104.108 | 4 247 4015 80 | Nut | 4 |



075.566

-

Brake Shoe Rep. Kit

| | SAMPA NR. | OEM NR. | DESCRIPTION | QTY. |
|----|----------------|----------------------------------|----------------------------|-----------|
| | 075.566 | - | Brake Shoe Rep. Kit | 30 |
| 1 | 075.039 | 1 447 0038 00 | Return Spring | 2 |
| 2 | 075.056 | 1 214 0023 02 (1 214 0023 01) | Anchor Pin | 2 |
| 3 | 105.026 | 1 331 0013 00 | Washer | 4 |
| 4 | 106.201 | 4 348 1004 00 | Circlip | 4 |
| 5 | 075.045 | 1 265 0007 00 | Cam Roller | 2 |
| 6 | 080.130 | 1 395 1005 00 | Brake Shoe Spring Pin | 2 |
| 7 | 085.036 | 1 230 0084 01 | Bushing | 2 |
| 8 | 114.144 | 1 345 0006 00 | Lock Plates | 4 |
| 9 | 102.103 | 4 343 1015 88 | Screw | 4 |
| 10 | 104.108 | 4 247 4015 80 | Nut | 4 |

075.567
3 005 0177 00
Dust Cover Set

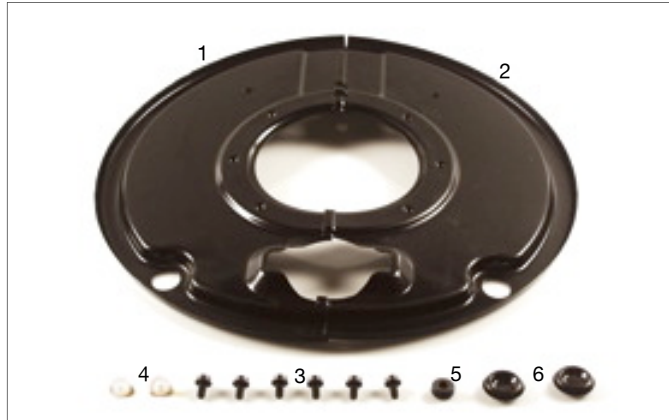

| | SAMPA NR. | OEM NR. | DESCRIPTION | QTY. |
|---|----------------|----------------------|-----------------------|-----------|
| | 075.567 | 3 005 0177 00 | Dust Cover Set | 13 |
| 1 | 114.245 | 1 005 0177 00 | Dust Cover | 1 |
| 2 | 114.246 | 1 005 0178 00 | Dust Cover | 1 |
| 3 | 102.353 | 4 375 4025 00 | Screw | 6 |
| 4 | 013.009 | 4 337 2027 00 | Plug | 2 |
| 5 | 211.048 | 4 177 3018 00 | Rubber Plug | 1 |
| 6 | 211.049 | 4 337 2008 01 | Rubber Plug | 2 |
| | | | | |
| | | | | |
| | | | | |

075.568
3 005 0135 00
Dust Cover Set

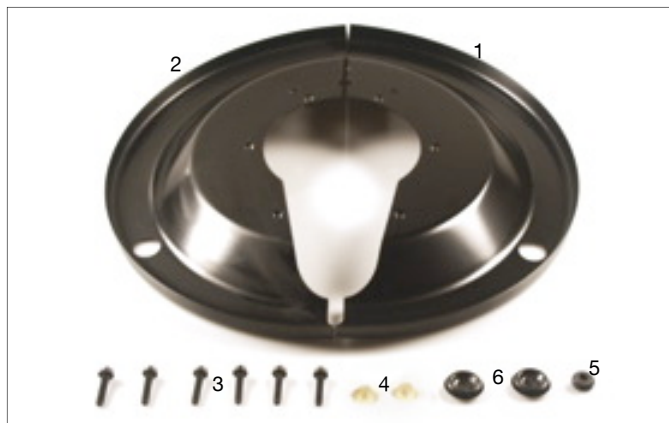

| | SAMPA NR. | OEM NR. | DESCRIPTION | QTY. |
|---|----------------|----------------------|-----------------------|-----------|
| | 075.568 | 3 005 0135 00 | Dust Cover Set | 13 |
| 1 | 114.247 | 2 005 0134 00 | Dust Cover | 1 |
| 2 | 114.248 | 2 005 0135 00 | Dust Cover | 1 |
| 3 | 102.354 | 4 375 4027 00 | Screw | 6 |
| 4 | 013.009 | 4 337 2027 00 | Plug | 2 |
| 5 | 211.048 | 4 177 3018 00 | Rubber Plug | 1 |
| 6 | 211.049 | 4 337 2008 01 | Rubber Plug | 2 |
| | | | | |
| | | | | |
| | | | | |

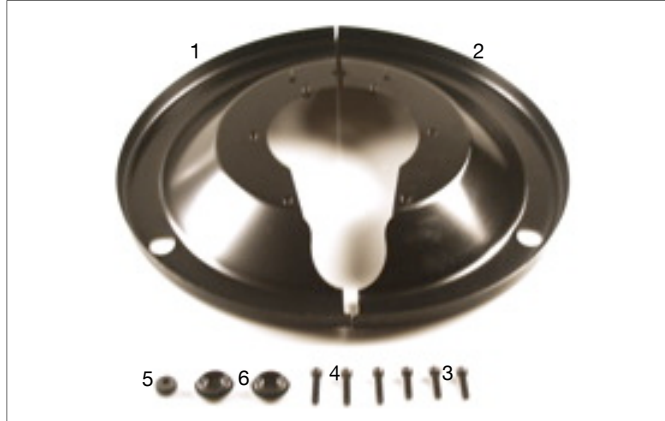

075.569
3 005 0139 00
Dust Cover Set

| | SAMPA NR. | OEM NR. | DESCRIPTION | QTY. |
|---|----------------|----------------------|-----------------------|-----------|
| | 075.569 | 3 005 0139 00 | Dust Cover Set | 11 |
| 1 | 114.249 | 2 005 0138 00 | Dust Cover | 1 |
| 2 | 114.250 | 2 005 0139 00 | Dust Cover | 1 |
| 3 | 102.355 | 4 375 4017 88 | Screw | 3 |
| 4 | 102.356 | 4 375 4019 88 | Screw | 3 |
| 5 | 211.048 | 4 177 3018 00 | Rubber Plug | 1 |
| 6 | 211.049 | 4 337 2008 01 | Rubber Plug | 2 |
| | | | | |
| | | | | |
| | | | | |

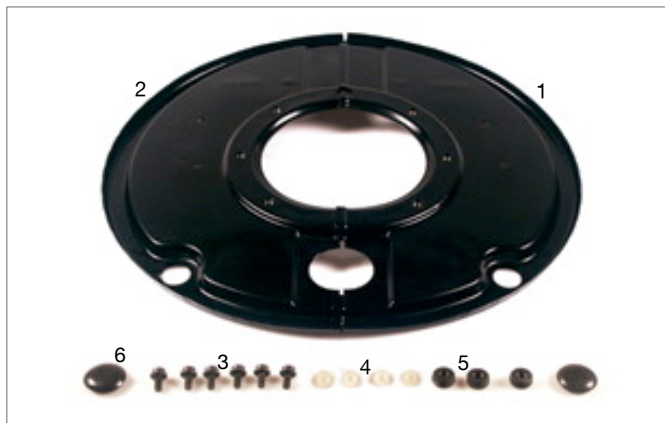

075.570
3 005 0149 00
Dust Cover Set

| | SAMPA NR. | OEM NR. | DESCRIPTION | QTY. |
|---|----------------|----------------------|-----------------------|-----------|
| | 075.570 | 3 005 0149 00 | Dust Cover Set | 17 |
| 1 | 114.251 | 2 005 0153 00 | Dust Cover | 1 |
| 2 | 114.252 | 2 005 0154 00 | Dust Cover | 1 |
| 3 | 102.353 | 4 375 4025 00 | Screw | 6 |
| 4 | 013.009 | 4 337 2027 00 | Plug | 4 |
| 5 | 211.048 | 4 177 3018 00 | Rubber Plug | 3 |
| 6 | 211.049 | 4 337 2008 01 | Rubber Plug | 2 |
| | | | | |
| | | | | |
| | | | | |

075.571
3 005 0159 00
Dust Cover Set



| | SAMPA NR. | OEM NR. | DESCRIPTION | QTY. |
|---|----------------|----------------------|-----------------------|----------|
| | 075.571 | 3 005 0159 00 | Dust Cover Set | 8 |
| 1 | 114.253 | 1 005 0159 00 | Dust Cover | 1 |
| 2 | 114.254 | 1 005 0160 00 | Dust Cover | 1 |
| 3 | 013.009 | 4 337 2027 00 | Plug | 2 |
| 4 | 211.048 | 4 177 3018 00 | Rubber Plug | 1 |
| 5 | 211.083 | 1 177 3025 00 | Rubber Seal | 1 |
| 6 | 102.152 | 4 343 1075 88 | Screw | 1 |
| 7 | 109.014 | 4 194 2025 00 | Metal Clamp | 1 |

075.572
3 005 0053 00
Dust Cover Set



| | SAMPA NR. | OEM NR. | DESCRIPTION | QTY. |
|---|----------------|----------------------|-----------------------|-----------|
| | 075.572 | 3 005 0053 00 | Dust Cover Set | 14 |
| 1 | 114.255 | 1 005 0053 00 | Dust Cover | 1 |
| 2 | 114.256 | 1 005 0054 00 | Dust Cover | 1 |
| 3 | 013.010 | 4 337 2007 00 | Plug | 2 |
| 4 | 013.009 | 4 337 2027 00 | Plug | 2 |
| 5 | 102.132 | 4 375 2003 88 | Screw | 4 |
| 6 | 107.001 | 4 141 0001 00 | Rondela | 4 |

SAUER ACHSEN



075.573
3 005 0045 00
Dust Cover Set

| | SAMPA NR. | OEM NR. | DESCRIPTION | QTY. |
|---|----------------|----------------------|-----------------------|-----------|
| | 075.573 | 3 005 0045 00 | Dust Cover Set | 15 |
| 1 | 114.257 | 1 005 0045 00 | Dust Cover | 1 |
| 2 | 114.258 | 1 005 0046 00 | Dust Cover | 1 |
| 3 | 211.048 | 4 177 3018 00 | Rubber Plug | 1 |
| 4 | 102.132 | 4 375 2003 88 | Screw | 6 |
| 5 | 107.001 | 4 141 0001 00 | Rondela | 6 |
| | | | | |
| | | | | |
| | | | | |



075.574
3 005 0125 00
Dust Cover Set

| | SAMPA NR. | OEM NR. | DESCRIPTION | QTY. |
|---|----------------|----------------------|-----------------------|----------|
| | 075.574 | 3 005 0125 00 | Dust Cover Set | 5 |
| 1 | 114.259 | 1 005 0124 00 | Dust Cover | 1 |
| 2 | 114.260 | 1 005 0125 00 | Dust Cover | 1 |
| 3 | 013.009 | 4 337 2027 00 | Plug | 2 |
| 4 | 109.008 | 4 194 2005 00 | Metal Clamp | 1 |
| | | | | |
| | | | | |
| | | | | |

O.E.M. Numbers are stated for comparison purposes only. It is not permitted to mention original numbers on invoices owners.

075.575
3 005 0161 00
Dust cover Set



| | SAMPA NR. | OEM NR. | DESCRIPTION | QTY. |
|---|----------------|----------------------|-----------------------|----------|
| | 075.575 | 3 005 0161 00 | Dust Cover Set | 9 |
| 1 | 114.261 | 1 005 0161 00 | Dust Cover | 1 |
| 2 | 114.262 | 1 005 0162 00 | Dust Cover | 1 |
| 3 | 102.152 | 4 343 1075 88 | Screw | 1 |
| 4 | 109.014 | 4 194 2025 00 | Metal Clamp | 1 |
| 5 | 013.009 | 4 337 2027 00 | Plug | 2 |
| 6 | 211.048 | 4 177 3018 00 | Rubber Plug | 1 |
| 7 | 211.049 | 4 337 2008 01 | Rubber Plug | 2 |

075.576
3 005 0171 00
Dust Cover Set



| | SAMPA NR. | OEM NR. | DESCRIPTION | QTY. |
|---|----------------|----------------------|-----------------------|----------|
| | 075.576 | 3 005 0171 00 | Dust Cover Set | 9 |
| 1 | 114.263 | 1 005 0171 00 | Dust Cover | 1 |
| 2 | 114.264 | 1 005 0172 00 | Dust Cover | 1 |
| 3 | 102.152 | 4 343 1075 88 | Screw | 1 |
| 4 | 109.014 | 4 194 2025 00 | Metal Clamp | 1 |
| 5 | 013.009 | 4 337 2027 00 | Plug | 2 |
| 6 | 211.048 | 4 177 3018 00 | Rubber Plug | 1 |
| 7 | 211.049 | 4 337 2008 01 | Rubber Plug | 2 |



075.577
3 050 1008 00
Bolt Assembly Rep. Kit
ø50.5x92x121

| | SAMPA NR. | OEM NR. | DESCRIPTION | QTY. |
|---|----------------|----------------------|-------------------------------|----------|
| | 075.577 | 3 050 1008 00 | Bolt Assembly Rep. Kit | 9 |
| 1 | 101.311 | 1 051 1008 00 | Bolt | 1 |
| 2 | 075.061 | 1 177 2002 00 | Rubber Bush | 2 |
| 3 | 105.271 | 1 331 0020 02 | Washer | 2 |
| 4 | 104.215 | 4 202 1006 80 | Castle Nut | 2 |
| 5 | 103.010 | 4 353 0014 00 | Cotter Pin | 2 |
| | | | | |
| | | | | |
| | | | | |



075.578
3 005 0183 00
Dust Cover Set
ø155xø331x26

| | SAMPA NR. | OEM NR. | DESCRIPTION | QTY. |
|---|----------------|----------------------|-----------------------|-----------|
| | 075.578 | 3 005 0183 00 | Dust Cover Set | 15 |
| 1 | 114.297 | 1 005 0183 00 | Dust Cover | 1 |
| 2 | 114.298 | 1 005 0184 00 | Dust Cover | 1 |
| 3 | 102.353 | 4 375 4025 00 | Screw | 6 |
| 4 | 013.009 | 4 337 2027 00 | Plug | 2 |
| 5 | 211.048 | 4 177 3018 00 | Rubber Plug | 1 |
| 6 | 211.049 | 4 337 2008 01 | Rubber Plug | 4 |
| | | | | |
| | | | | |
| | | | | |



SAUER ACHSEN

075.579
3 005 0057 00
Dust Cover Set
ø140xø349x34



| | SAMPA NR. | OEM NR. | DESCRIPTION | QTY. |
|---|----------------|----------------------|-----------------------|-----------|
| | 075.579 | 3 005 0057 00 | Dust Cover Set | 12 |
| 1 | 114.299 | 1 005 0057 00 | Dust Cover | 1 |
| 2 | 114.300 | 1 005 0058 00 | Dust Cover | 1 |
| 3 | 102.132 | 4 375 2003 88 | Screw | 4 |
| 4 | 107.001 | 4 141 0001 00 | Rondela | 4 |
| 5 | 013.010 | 4 337 2007 00 | Plug | 2 |
| | | | | |
| | | | | |
| | | | | |

075.580
3 005 0079 00
Dust Cover Set
ø149xø29.5x50



| | SAMPA NR. | OEM NR. | DESCRIPTION | QTY. |
|---|----------------|----------------------|-----------------------|----------|
| | 075.580 | 3 005 0079 00 | Dust Cover Set | 6 |
| 1 | 114.301 | 1 005 0079 00 | Dust Cover | 1 |
| 2 | 114.134 | 1 005 0056 00 | Dust Cover | 1 |
| 3 | 013.009 | 4 337 2027 00 | Plug | 2 |
| 4 | 013.010 | 4 337 2007 00 | Plug | 2 |
| | | | | |
| | | | | |
| | | | | |

O.E.M. Numbers are stated for comparison purposes only. It is not permitted to mention original numbers on invoices owners.

DIAPHRAGMS

MEMBRANS



095.101
897 120 492.4
Type 9"
Short Stroke



095.103
897 120 505.4
Type 12"
Short Stroke



095.105
897 120 510.4
Type 16"
Short Stroke



095.106
897 120 520.4
Type 20"
Short Stroke



095.107
897 120 530.4
Type 24"
Short Stroke



095.108
897 120 540.4
Type 30"
Short Stroke

095.109
897 120 550.4
Type 36"
Short Stroke



095.110
897 120 516.4
Type 16"
Long Stroke



095.111
897 120 526.4
Type 20"
Long Stroke



095.112
897 120 536.4
Type 24"
Long Stroke



095.113
897 120 546.4
Type 30"
Long Stroke



COUPLINGS



095.001
452 200 211 0
Automatic
Coupling, Red
M22x1.5



095.002
952 200 221 0
Automatic
Coupling, Red
M16x1.5



095.004
452 200 212 0
Automatic
Coupling, Yellow
M22x1.5



095.005
952 200 222 0
Automatic
Coupling, Yellow
M16x1.5

095.006
452 200 011 0
Palm Coupling, Red
M22x1.5



095.007
952 200 021 0
Palm Coupling, Red
M16x1.5



095.008
452 200 012 0
Palm Coupling, Yellow
M22x1.5



095.009
952 200 022 0
Palm Coupling, Yellow
M16x1.5



095.010
897 550 020 4
Rubber Seal
19x28.5x41.5



UNIVERSAL PARTS



095.011
432 500 020 0
Air-Line Filter
M22x1.5



095.012
452 002 107 0
Shut-Off Cock
M22x1.5



095.013
973 500 000 0
Air Valve
M22X1.5



095.014
-
Plug
7 Core White

095.015
-
Socket
7 Core



095.016
-
Plug
7 Core Black



095.017
-
Socket
7 Core



UNIVERSAL PARTS



095.021
-
Electrical Coil
7 Core 12/24V
With 2 Metal Plugs

095.041
(B0 481 007 0 29)
(W463 013 110 0)
Brake Valve
M12X1.5



095.022
-
Spanset
8m.

095.042
(B0 481 007 0 10)
(W463 013 114 0)
Brake Valve
M12X1.5



095.023
-
Spanset
10m.



095.043
(B0 481 019 002)
(W934 300 003 0)
Drain Valve
M22X1.5



095.024
-
Spanset
12m.

SAUER ACHSEN



| | | O.E.M. NR. | SAMPA NR. | DESCRIPTION |
|---|---------------|---------------|-----------|-------------|
|  | M156x2xSW85 | 4 011 0039 01 | 075.064 | Axle Nut |
|  | M156x2xSW85 | 2 011 0040 01 | 075.065 | Axle Nut |
|  | ø56.5xø93x4.5 | 1 345 0008 01 | 075.066 | Lock Plate |
| | | | | |
| | | | | |

O.E.M. Numbers are stated for comparison purposes only. It is not permitted to mention original numbers on invoices owners.

